



BOCK Semi-hermetic Compressors

Single- and two-stage reciprocating
Bock compressors (HG/HA)

BOCK

colour the world
of tomorrow

HG semi-hermetic compressors

At a glance

Special features:

- o Outstanding running comfort
- o Efficiency and reliability on the highest level of quality
- o Service-friendly design, e.g. with replaceable drive motors
- o Oil pump lubrication
- o Electronic motor protection
- o Suitable components for conventional or chlorine-free HFC refrigerants

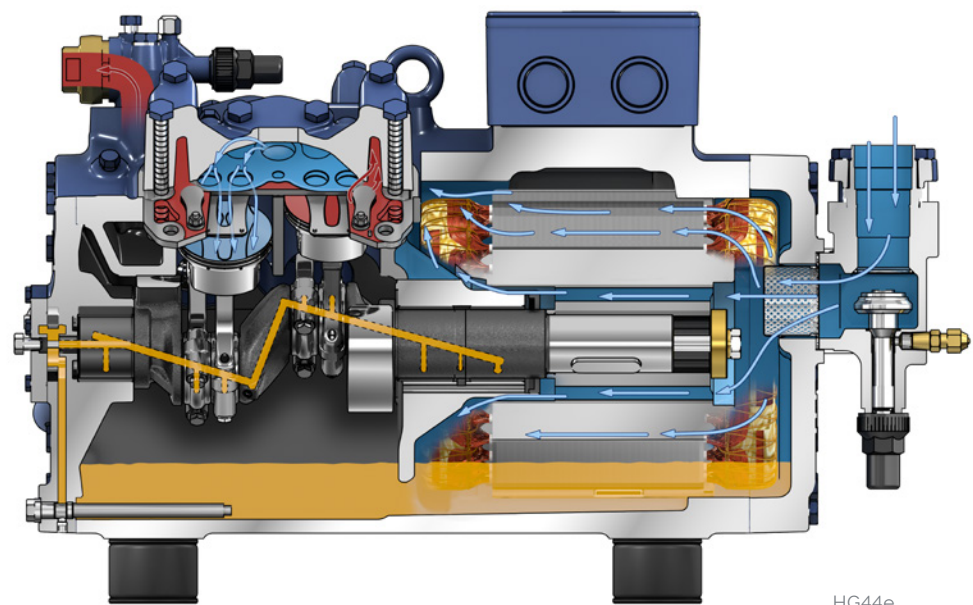

Type key

HGX66e / 2070 - 4S

- Series ¹⁾
- Ester oil filling ²⁾
- Size
- Number of cylinders
- e-series ³⁾
- Swept volume
- Number of poles
- Motor variant ⁴⁾

¹⁾ HG = Hermetic Gas-cooled (suction gas-cooled)

²⁾ X = Ester oil filling (HFC refrigerants e.g. R134a, R404A, R448A, R449A)

³⁾ = Additional declaration for e-series compressors

⁴⁾ S = More powerful motor e.g. air-conditioning applications

HG semi-hermetic compressors

Performance data

R134a 50 Hz													
Type		Cooling capacity Q_0 [kW]						Power consumption P_e [kW]					
		Evaporating temperature °C											
		12.5	10	7.5	5	0	-5	-10	-15	-20	-25	-30	
Cond. temp. °C													
		HGX44e/770-4	30	Q	63600	58000	52800	47900	39100	31600	25100	19700	15100
	P		7.62	7.68	7.70	7.67	7.48	7.14	6.69	6.14	5.54	4.90	4.25
40	Q		56000	51100	46400	42100	34200	27500	21800	16900	12800	9360	6460
	P		9.63	9.54	9.42	9.24	8.79	8.21	7.53	6.78	5.99	5.19	4.40
50	Q		48700	44200	40100	36300	29500	23600	18600	14300	10700	7510	4830
	P		11.5	11.2	11.0	10.7	9.97	9.14	8.23	7.26	6.28	5.30	4.35
HHGX56e/850-4	30	Q	71500	65200	59400	53900	43900	35300	28000	21700	16500	12300	8870
		P	8.74	8.80	8.79	8.74	8.49	8.08	7.52	6.86	6.11	5.30	4.45
	40	Q	62900	57400	52200	47300	38500	30900	24300	18800	14200	10400	7330
		P	11.1	10.9	10.8	10.5	9.99	9.27	8.43	7.50	6.51	5.48	4.45
	50	Q	54500	49600	45000	40700	33000	26400	20700	15900	11900	8470	5720
		P	13.2	12.9	12.5	12.1	11.2	10.2	9.11	7.93	6.71	5.47	4.26
HGX56e/995-4	30	Q	82900	75700	68900	62500	51000	41000	32400	25100	19000	14000	10100
		P	10.1	10.1	10.1	10.1	9.81	9.29	8.62	7.81	6.92	5.98	5.03
	40	Q	73100	66600	60600	54900	44700	35800	28100	21600	16200	11700	8050
		P	12.7	12.6	12.4	12.1	11.4	10.6	9.60	8.51	7.36	6.20	5.05
	50	Q	63200	57600	52300	47300	38300	30500	23900	18100	13300	9260	5930
		P	15.2	14.8	14.4	13.9	12.9	11.6	10.3	8.98	7.58	6.19	4.85
HGX56e/1155-4	30	Q	94600	86200	78400	71100	57800	46400	36600	28400	21600	16000	11700
		P	13.0	12.9	12.8	12.6	12.0	11.2	10.3	9.31	8.24	7.16	6.12
	40	Q	83600	76200	69200	62600	50800	40700	32000	24700	18600	13600	9550
		P	15.9	15.6	15.3	14.9	13.9	12.8	11.5	10.2	8.85	7.51	6.24
	50	Q	72600	66000	59900	54100	43800	34900	27300	20800	15500	11000	7340
		P	18.7	18.2	17.6	17.0	15.6	14.1	12.5	10.8	9.21	7.60	6.08
HGX66e/1340-4	30	Q	109000	99700	91100	82900	68000	54900	43600	33900	25800	19100	13800
		P	14.0	14.2	14.2	14.1	13.6	12.9	12.0	10.8	9.66	8.40	7.16
	40	Q	97000	88700	80800	73400	59900	48000	37800	29100	21800	15800	11100
		P	17.7	17.5	17.2	16.8	15.8	14.5	13.1	11.6	10.1	8.65	7.22
	50	Q	84400	76900	69900	63300	51300	40800	31800	24200	17900	12700	-
		P	20.9	20.4	19.7	19.0	17.5	15.8	14.0	12.1	10.3	8.62	-
HGX66e/1540-4	30	Q	125000	115000	105000	95200	78200	63300	50400	39300	30000	22300	16200
		P	16.1	16.2	16.3	16.2	15.7	14.9	13.8	12.5	11.1	9.74	8.33
	40	Q	112000	102000	92900	84400	69000	55500	43900	33900	25500	18700	13200
		P	20.4	20.2	19.8	19.4	18.2	16.8	15.2	13.5	11.8	10.1	8.50
	50	Q	97000	88500	80500	73000	59300	47400	37100	28400	21100	15200	-
		P	24.2	23.6	22.9	22.1	20.3	18.3	16.3	14.2	12.1	10.2	-
HGX66e/1750-4	30	Q	143000	131000	120000	109000	89400	72400	57600	44900	34300	25600	18600
		P	18.4	18.6	18.6	18.5	17.9	17.0	15.8	14.4	12.8	11.2	9.67
	40	Q	128000	117000	107000	96600	79000	63600	50200	38800	29300	21400	15200
		P	23.3	23.0	22.6	22.1	20.8	19.2	17.5	15.5	13.6	11.7	9.89
	50	Q	111000	102000	92200	83600	67900	54300	42500	32600	24200	17400	-
		P	27.6	26.9	26.1	25.2	23.2	21.0	18.7	16.3	14.0	11.8	-
HGX66e/1750-4	60	Q	94100	85600	77600	70100	56600	44900	34900	26500	19500	-	-
		P	31.3	30.2	29.0	27.7	25.1	22.3	19.4	16.7	14.0	-	-
	70	Q	76700	69500	62800	56500	45200	35600	27500	20800	-	-	-
		P	34.3	32.8	31.2	29.6	26.3	23.0	19.7	16.5	-	-	-

Relating to 20 °C suction gas temperature without liquid subcooling

 Supplementary cooling or reduced suction gas temperature

vap.bock.de 

HG semi-hermetic compressors

Performance data

R134a | 50 Hz

Type		Cooling capacity Q_o [kW]										Power consumption P_e [kW]			
		Evaporating temperature °C													
Cond. temp. °C		12.5	10	7.5	5	0	-5	-10	-15	-20	-25	-30			
HGX66e/2070-4	30	Q	168000	154000	141000	129000	106000	85300	67900	53000	40500	30200	22000		
		P	217	219	219	218	211	20.0	186	16.9	15.0	13.1	11.2		
	40	Q	150000	137000	125000	114000	93000	74900	59200	45800	34500	25300	17900		
		P	276	272	26.7	26.1	24.6	22.7	20.6	18.3	15.9	13.7	11.5		
	50	Q	131000	120000	109000	98300	79900	63900	50100	38400	28600	20600	-		
		P	32.8	31.9	30.9	29.9	27.5	24.8	22.0	19.2	16.4	13.8	-		
	60	Q	111000	101000	91100	82400	66500	52800	41100	31200	23000	-	-		
		P	37.3	35.9	34.4	32.9	29.7	26.3	22.9	19.6	16.5	-	-		
	70	Q	89900	81500	73700	66300	53200	41900	32400	24600	-	-	-		
		P	40.9	39.0	37.1	35.2	31.2	27.2	23.2	19.4	-	-	-		
HGX88e/2400-4	30	Q	197000	181000	165000	151000	124000	99900	79500	62000	47400	35300	25700		
		P	26.1	26.3	26.3	26.1	25.4	24.2	22.5	20.6	18.4	16.1	13.8		
	40	Q	176000	161000	147000	134000	110000	87800	69400	53700	40500	29600	21000		
		P	32.8	32.4	31.8	31.1	29.4	27.2	24.8	22.2	19.5	16.8	14.2		
	50	Q	154000	141000	128000	116000	94000	75100	58900	45100	33600	24200	-		
		P	38.8	37.8	36.7	35.4	32.7	29.7	26.5	23.3	20.1	17.0	-		
	60	Q	131000	119000	108000	97100	78400	62200	48300	36700	27100	-	-		
		P	44.0	42.4	40.7	38.9	35.3	31.5	27.6	23.8	20.2	-	-		
	70	Q	107000	96400	87100	78400	62800	49400	38200	29000	-	-	-		
		P	48.2	46.1	43.9	41.6	37.1	32.5	28.0	23.7	-	-	-		
HGX88e/2735-4	30	Q	225000	206000	188000	171000	141000	114000	90500	70600	53900	40200	29300		
		P	29.9	30.1	30.1	29.9	29.0	27.6	25.8	23.5	21.1	18.5	15.8		
	40	Q	201000	184000	168000	152000	125000	100000	79000	61100	46100	33700	23900		
		P	37.4	36.9	36.3	35.5	33.5	31.1	28.4	25.4	22.3	19.2	16.3		
	50	Q	176000	160000	146000	132000	108000	85600	67100	51400	38200	27500	-		
		P	44.1	43.0	41.7	40.3	37.3	33.9	30.3	26.7	23.0	19.5	-		
	60	Q	149000	136000	123000	111000	89400	70900	55100	41800	30900	-	-		
		P	49.8	48.1	46.2	44.3	40.2	35.9	31.5	27.2	23.1	-	-		
	70	Q	122000	111000	99400	89400	71600	56300	43500	33000	-	-	-		
		P	54.5	52.2	49.7	47.2	42.2	37.0	32.0	27.1	-	-	-		
HGX88e/3235-4	30	Q	265000	243000	222000	202000	166000	135000	107000	83300	63500	47300	34400		
		P	35.2	35.4	35.4	35.2	34.2	32.5	30.3	27.6	24.7	21.6	18.5		
	40	Q	237000	217000	198000	180000	147000	118000	93200	72000	54200	39600	28000		
		P	44.1	43.5	42.7	41.8	39.4	36.6	33.3	29.8	26.1	22.5	18.9		
	50	Q	207000	189000	172000	156000	127000	101000	78900	60400	44900	32300	-		
		P	52.0	50.6	49.1	47.5	43.8	39.8	35.6	31.2	26.9	22.7	-		
	60	Q	176000	160000	145000	131000	106000	83400	64700	49100	36100	-	-		
		P	58.7	56.6	54.4	52.1	47.2	42.1	37.0	31.8	26.9	-	-		
	70	Q	144000	130000	117000	106000	84200	66200	51100	38600	-	-	-		
		P	64.3	61.4	58.5	55.6	49.5	43.4	37.4	31.5	-	-	-		

Relating to 20 °C suction gas temperature without liquid subcooling

Supplementary cooling or reduced suction gas temperature



HG semi-hermetic compressors

Performance data

R513A | 50 Hz

Type		Cooling capacity Q_0 [kW]						Power consumption P_e [kW]					
		Evaporating temperature °C											
Cond. temp. °C		12.5	10	7.5	5	0	-5	-10	-15	-20	-25	-30	
		HGX44e/770-4 HGX44e/770-4 S	30	Q 65200 P 793	59700 8.01	54600 8.04	49700 8.03	41000 7.86	33400 7.55	26800 7.11	21200 6.57	16500 5.96	12500 5.31
40	Q 57000 P 10.0		52100 9.95	47500 9.83	43300 9.68	35500 9.24	28800 8.68	23100 8.02	18200 7.27	14000 6.47	10400 5.65	7400 4.83	
50	Q 48800 P 11.9		44500 11.7	40500 11.4	36800 11.1	30100 10.4	24300 9.66	19400 8.76	15100 7.80	11500 6.81	8350 5.81	5680 4.82	
60	Q 40500 P 13.6		36900 13.2	33500 12.8	30300 12.4	24700 11.4	19800 10.3	15700 9.24	12100 8.06	8970 6.87	6300 5.68	3940 4.53	
70	Q 32200 P 15.0		29200 14.4	26400 13.9	23800 13.3	19200 12.0	15300 10.7	11900 9.36	8940 7.95	6420 6.55	-	-	
HGX56e/850-4 HGX56e/850-4 S	30		Q 73600 P 9.23	67400 9.29	61600 9.30	56200 9.26	46100 8.96	37400 8.57	30000 8.03	23600 7.37	18200 6.62	13700 5.80	10100 4.94
	40	Q 64200 P 11.6	58800 11.5	53600 11.3	48800 11.1	39900 10.5	32400 9.83	25800 9.00	20200 8.08	15500 7.09	11600 6.05	8310 5.00	
	50	Q 54800 P 13.7	50000 13.4	45600 13.1	41400 12.7	33700 11.8	27200 10.8	21600 9.76	16900 8.58	12800 7.35	9360 6.11	6530 4.87	
	60	Q 45300 P 15.6	41300 15.2	37500 14.7	34000 14.1	27600 12.9	22100 11.6	17500 10.2	13500 8.85	10100 7.40	7170 5.95	4750 4.53	
	70	Q 35800 P 17.3	32500 16.6	29500 15.9	26600 15.2	21400 13.8	17000 12.2	13300 10.5	10100 8.89	7350 7.21	-	-	
	HGX56e/995-4 HGX56e/995-4 S	30	Q 85100 P 10.5	78000 10.6	71300 10.6	65000 10.6	53500 10.3	43400 9.86	34700 9.20	27200 8.40	20900 7.51	15700 6.56	11500 5.57
40		Q 74300 P 13.3	68100 13.2	62200 13.0	56600 12.7	46400 12.0	37500 11.2	29900 10.2	23300 9.18	17700 8.03	13100 6.84	9200 5.66	
50		Q 63400 P 15.8	58000 15.5	52800 15.1	48000 14.6	39200 13.6	31600 12.4	25000 11.1	19300 9.73	14500 8.32	10400 6.90	6940 5.51	
60		Q 52400 P 18.0	47800 17.5	43500 16.9	39400 16.2	31900 14.8	25600 13.2	20000 11.6	15300 9.98	11200 8.30	7660 6.65	4660 5.07	
70		Q 41300 P 19.8	37600 19.1	34000 18.2	30700 17.4	24700 15.6	19600 13.7	15100 11.8	11300 9.84	7910 7.91	-	-	
HGX56e/1155-4 HGX56e/1155-4 S		30	Q 98000 P 13.8	89700 13.8	81900 13.7	74500 13.5	60700 12.7	49200 11.9	39300 11.0	30800 10.0	23700 8.95	17900 7.83	13200 6.72
	40	Q 85900 P 16.8	78500 16.5	71600 16.2	65100 15.8	52800 14.7	42700 13.6	34000 12.3	26500 11.0	20300 9.65	15100 8.26	10800 6.91	
	50	Q 73500 P 19.5	67100 19.1	61100 18.5	55500 18.0	44800 16.5	36100 15.0	28600 13.4	22200 11.7	16700 10.1	12200 8.43	8410 6.83	
	60	Q 61000 P 22.1	55500 21.4	50400 20.6	45700 19.8	36700 18.0	29400 16.1	23100 14.2	17700 12.1	13200 10.1	9280 8.21	6030 6.34	
	70	Q 48300 P 24.2	43900 23.3	39700 22.3	35800 21.3	28500 19.1	22600 16.8	17600 14.5	13300 12.1	9600 9.76	-	-	
	HGX66e/1340-4 HGX66e/1340-4 S	30	Q 116000 P 15.4	106000 15.5	96700 15.4	88100 15.3	72200 14.6	58700 13.7	47000 12.7	36900 11.5	28500 10.3	21500 9.06	15800 7.85
40		Q 102000 P 18.9	93100 18.6	84900 18.3	77200 17.8	62900 16.7	50800 15.4	40300 13.9	31400 12.4	23800 10.8	17600 9.33	12500 7.90	
50		Q 87200 P 21.9	79600 21.4	72400 20.8	65600 20.1	53000 18.4	42500 16.7	33400 14.9	25700 13.0	19300 11.1	14000 9.36	9660 7.74	
60		Q 72100 P 24.5	65500 23.7	59300 22.8	53600 21.9	42900 19.8	34100 17.6	26600 15.4	20400 13.2	15200 11.0	11000 9.09	7580 7.29	
70		Q 56500 P 26.6	51100 25.5	46100 24.4	41500 23.2	32900 20.7	26000 18.1	20300 15.5	15600 13.0	11800 10.6	8800 8.45	-	
HGX66e/1540-4 HGX66e/1540-4 S		30	Q 133000 P 17.6	122000 17.7	111000 17.6	102000 17.5	83100 16.8	67600 15.8	54300 14.7	42800 13.3	33100 11.9	25100 10.5	18600 9.13
	40	Q 117000 P 21.7	107000 21.4	97700 21.0	88900 20.5	72500 19.3	58700 17.8	46700 16.1	36500 14.4	27800 12.6	20700 10.9	14900 9.29	
	50	Q 101000 P 25.3	91600 24.7	83400 24.0	75700 23.2	61300 21.4	49200 19.4	38900 17.3	30100 15.2	22700 13.0	16600 11.0	11700 9.22	
	60	Q 83100 P 28.4	75600 27.5	68500 26.5	62000 25.4	49800 23.1	39700 20.6	31200 18.1	24000 15.5	18000 13.1	13200 10.8	9310 8.85	
	70	Q 65300 P 30.9	59200 29.7	53400 28.4	48100 27.1	38400 24.2	30500 21.3	23900 18.3	18500 15.5	14200 12.8	10800 10.3	-	
	HGX66e/1750-4 HGX66e/1750-4 S	30	Q 151000 P 20.2	138000 20.3	126000 20.2	115000 20.0	95000 19.2	77300 18.1	62000 16.8	48900 15.3	37900 13.7	28700 12.1	21300 10.5
40		Q 133000 P 24.8	122000 24.5	111000 24.1	101000 23.5	82900 22.0	67100 20.4	53500 18.5	41800 16.5	31900 14.5	23700 12.6	17100 10.7	
50		Q 114000 P 29.0	104000 28.3	94700 27.5	86000 26.6	70200 24.5	56400 22.2	44600 19.8	34500 17.4	26100 15.0	19100 12.8	13500 10.7	
60		Q 94300 P 32.6	85800 31.5	77900 30.4	70500 29.1	57100 26.4	45600 23.6	35800 20.7	27600 17.9	20800 15.2	15200 12.6	10800 10.3	
70		Q 74200 P 35.5	67200 34.0	60800 32.6	54800 31.0	44000 27.7	35000 24.4	27500 21.1	21300 17.9	16400 14.8	12500 12.0	-	

Relating to 20 °C suction gas temperature without liquid subcooling

Motor version -S- (more powerful motor)

Supplementary cooling or reduced suction gas temperature

vap.bock.de



HG semi-hermetic compressors

Performance data

R513A | 50 Hz

Type		Cooling capacity Q_o [kW]										Power consumption P_e [kW]			
		Evaporating temperature °C													
Cond. temp. °C		12.5	10	7.5	5	0	-5	-10	-15	-20	-25	-30			
		HGX66e/2070-4 HGX66e/2070-4 S	30	Q	177000	163000	149000	136000	112000	91100	73100	57700	44700	33900	25100
	P		23.8	23.9	23.8	23.6	22.6	21.3	19.8	18.0	16.1	14.1	12.3		
40	Q		157000	143000	131000	119000	97600	79100	63000	49200	37600	28000	20200		
	P		29.3	29.0	28.4	27.8	26.0	24.0	21.8	19.4	17.0	14.7	12.6		
50	Q		134000	123000	112000	102000	82500	66400	52500	40700	30800	22600	15900		
	P		34.3	33.5	32.5	31.5	29.0	26.3	23.4	20.5	17.7	15.0	12.5		
HGX88e/2400-4 HGX88e/2400-4 S	30	Q	209000	192000	175000	160000	131000	107000	85600	67500	52300	39600	29400		
		P	28.9	28.9	28.8	28.6	27.1	25.7	23.9	21.8	19.6	17.3	15.1		
	40	Q	185000	169000	155000	141000	115000	92800	73900	57700	44100	32900	23700		
		P	35.1	34.7	34.1	33.4	31.0	28.8	26.2	23.5	20.8	18.1	15.5		
	50	Q	159000	145000	132000	120000	97100	78100	61700	47800	36100	26500	18800		
		P	40.7	39.8	38.7	37.5	34.4	31.4	28.1	24.8	21.5	18.4	15.5		
HGX88e/2735-4 HGX88e/2735-4 S	30	Q	237000	218000	199000	182000	150000	122000	97500	76900	59500	45100	33500		
		P	32.6	32.6	32.5	32.2	30.9	29.3	27.3	25.0	22.5	19.9	17.3		
	40	Q	210000	192000	176000	160000	131000	106000	84200	65800	50300	37400	27000		
		P	39.7	39.2	38.5	37.7	35.4	32.8	30.0	26.9	23.8	20.7	17.7		
	50	Q	181000	165000	150000	137000	111000	89000	70300	54500	41200	30200	21400		
		P	46.1	45.0	43.8	42.4	39.2	35.8	32.1	28.4	24.7	21.1	17.7		
HGX88e/3235-4 HGX88e/3235-4 S	30	Q	280000	257000	235000	215000	177000	144000	116000	90700	70100	53100	39300		
		P	38.4	38.5	38.4	38.0	36.4	34.5	32.1	29.3	26.3	23.3	20.2		
	40	Q	248000	227000	207000	189000	155000	125000	99200	77500	59100	43900	31600		
		P	46.8	46.2	45.4	44.4	41.6	38.6	35.2	31.6	27.9	24.2	20.7		
	50	Q	213000	195000	177000	161000	131000	105000	82800	64000	48300	35400	25000		
		P	54.3	53.0	51.5	49.9	46.1	42.0	37.7	33.3	28.8	24.6	20.6		
HGX88e/3235-4 HGX88e/3235-4 S	60	Q	177000	161000	146000	132000	107000	84700	66500	51100	38500	28200	20100		
		P	60.7	58.8	56.7	54.5	49.7	44.6	39.3	34.1	29.0	24.2	19.9		
	70	Q	139000	126000	114000	103000	82000	65100	51000	39600	30400	23200	-		
		P	65.9	63.4	60.7	57.9	52.1	46.1	40.0	34.0	28.3	23.0	-		

Relating to 20 °C suction gas temperature
without liquid subcooling

Motor version -S-
(more powerful motor)

Supplementary cooling or
reduced suction gas temperature

vap.bock.de 

HG semi-hermetic compressors

Performance data

R404A/R507 | 50 Hz

Type		Cooling capacity Q_0 [kW]											Power consumption P_e [kW]			
		Evaporating temperature °C														
		7.5	5	0	-5	-10	-15	-20	-25	-30	-35	-40	-45			
Cond. temp. °C																
HGX34e/380-4 HGX34e/380-4 S	30	Q	40900	37600	31700	25800	21200	17300	13800	10900	8300	6200	4490	3120		
		P	7.20	7.15	6.98	6.84	6.45	5.98	5.46	4.88	4.28	3.67	3.05	2.45		
	40	Q	34600	31800	26700	21600	17700	14300	11400	8850	6730	4960	3510	2340		
		P	8.75	8.59	8.18	7.84	7.25	6.59	5.90	5.18	4.45	3.72	3.00	2.33		
	50	Q	28400	26000	21800	17600	14300	11500	9030	6960	5210	3760	2550	-		
		P	10.1	9.86	9.23	8.73	7.92	7.08	6.22	5.34	4.47	3.62	2.81	-		
HGX44e/475-4 HGX44e/475-4 S	30	Q	52500	48300	40200	33500	27500	22400	18000	14300	11100	8340	6060	4110		
		P	7.73	7.85	7.91	7.80	7.52	7.10	6.57	5.94	5.26	4.54	3.81	3.11		
	40	Q	45200	41400	34200	28300	23200	18800	15000	11800	9010	6670	4650	2870		
		P	9.97	9.90	9.62	9.16	8.57	7.88	7.12	6.31	5.47	4.64	3.84	3.11		
	50	Q	37600	34300	28100	23100	18800	15100	12000	9260	6970	5000	3270	-		
		P	11.8	11.5	11.0	10.2	9.41	8.49	7.55	6.59	5.65	4.76	3.94	-		
HGX44e/565-4 HGX44e/565-4 S	30	Q	62700	57700	47800	39800	32800	26800	21600	17200	13400	10200	7470	5140		
		P	9.18	9.32	9.45	9.31	8.97	8.47	7.82	7.07	6.24	5.38	4.51	3.66		
	40	Q	54000	49600	40700	33700	27700	22500	18100	14300	11100	8230	5820	3680		
		P	11.8	11.7	11.5	10.9	10.2	9.42	8.49	7.51	6.50	5.50	4.55	3.67		
	50	Q	45100	41200	33400	27500	22500	18200	14500	11400	8620	6270	4180	-		
		P	14.0	13.7	13.2	12.3	11.2	10.1	9.01	7.85	6.72	5.64	4.66	-		
HGX44e/665-4 HGX44e/665-4 S	30	Q	73100	67100	56000	46500	38300	31100	25000	19800	15300	11600	8340	5630		
		P	10.7	10.9	11.0	10.9	10.5	9.94	9.19	8.32	7.36	6.35	5.33	4.34		
	40	Q	62700	57400	47500	39300	32200	26000	20800	16300	12500	9160	6360	3910		
		P	13.9	13.8	13.4	12.8	12.0	11.0	9.97	8.83	7.66	6.49	5.37	4.34		
	50	Q	52000	47500	38900	32000	26000	20900	16500	12800	9570	6840	4440	-		
		P	16.5	16.1	15.4	14.3	13.1	11.8	10.5	9.22	7.91	6.66	5.51	-		
HGX44e/770-4 HGX44e/770-4 S	30	Q	84600	77800	65300	54300	44700	36500	29400	23300	18100	13800	10100	6840		
		P	12.4	12.6	12.8	12.6	12.1	11.5	10.6	9.62	8.51	7.34	6.16	5.02		
	40	Q	72600	66500	55600	46100	37800	30700	24500	19300	14900	11100	7750	4860		
		P	16.1	16.0	15.5	14.8	13.8	12.7	11.5	10.2	8.86	7.51	6.22	5.02		
	50	Q	60300	55100	45700	37600	30700	24700	19600	15300	11600	8360	5530	-		
		P	19.2	18.8	17.8	16.5	15.2	13.7	12.2	10.6	9.15	7.70	6.37	-		
HGX56e/850-4 HGX56e/850-4 S	30	Q	93700	86100	71800	59800	49300	40200	32400	25800	20100	15300	11200	7710		
		P	13.7	13.9	14.1	13.9	13.4	12.6	11.7	10.6	9.38	8.08	6.77	5.49		
	40	Q	80500	73800	61100	50600	41600	33800	27200	21400	16600	12400	8720	5520		
		P	17.7	17.6	17.1	16.3	15.3	14.0	12.7	11.2	9.76	8.27	6.83	5.50		
	50	Q	67000	61200	50100	41300	33800	27300	21800	17000	13000	9410	6280	-		
		P	21.1	20.6	19.6	18.3	16.8	15.1	13.4	11.7	10.0	8.48	7.00	-		
HGX56e/995-4 HGX56e/995-4 S	30	Q	111000	102000	85000	70800	58300	47400	38000	29800	22900	17100	12200	8120		
		P	18.6	18.3	17.6	16.7	15.8	14.6	13.4	12.1	10.7	9.21	7.61	5.94		
	40	Q	94300	86600	72100	59800	49000	39600	31500	24500	18500	13400	9110	5480		
		P	22.0	21.5	20.4	19.2	17.8	16.3	14.7	12.9	11.1	9.23	7.23	5.15		
	50	Q	78000	71400	59000	48600	39500	31700	24900	19100	14100	9800	6130	-		
		P	25.3	24.6	23.1	21.4	19.6	17.6	15.5	13.4	11.1	8.75	6.30	-		
HGX56e/1155-4 HGX56e/1155-4 S	30	Q	127000	117000	97500	81100	66800	54500	43900	34800	27100	20600	15000	10300		
		P	19.4	19.7	20.0	19.7	19.0	17.9	16.6	15.0	13.2	11.4	9.59	7.80		
	40	Q	109000	99900	83000	68800	56400	45800	36700	28900	22200	16600	11700	7280		
		P	25.1	24.9	24.4	23.2	21.7	19.9	18.0	15.9	13.8	11.7	9.68	7.80		
	50	Q	90600	82800	68200	56200	45800	36900	29300	22900	17300	12500	8270	-		
		P	29.9	29.2	27.9	26.0	23.8	21.5	19.1	16.6	14.2	12.0	9.91	-		
HGX66e/1340-4 HGX66e/1340-4 S	30	Q	150000	138000	115000	95700	78800	64100	51300	40400	31000	23100	16500	11000		
		P	25.0	24.9	24.2	23.2	21.9	20.3	18.5	16.5	14.4	12.3	10.3	8.30		
	40	Q	129000	118000	97900	81200	66600	53800	42800	33400	25400	18500	12700	-		
		P	30.3	29.7	28.4	26.6	24.5	22.3	19.9	17.4	14.9	12.5	10.1	-		
	50	Q	106000	97000	79900	65900	53700	43100	34100	26400	19800	14200	-	-		
		P	34.9	33.9	31.8	29.3	26.6	23.8	20.9	17.9	15.0	12.2	-	-		
HGX66e/1540-4 HGX66e/1540-4 S	30	Q	172000	158000	132000	110000	90700	73900	59400	46900	36200	27100	19500	13200		
		P	28.8	28.6	28.0	26.9	25.4	23.5	21.5	19.2	16.9	14.5	12.1	9.87		
	40	Q	148000	136000	113000	93400	76800	62300	49700	39000	29800	21900	15300	-		
		P	35.1	34.4	32.9	30.9	28.6	26.0	23.3	20.4	17.6	14.7	12.0	-		
	50	Q	122000	112000	91900	75900	62100	50100	39800	31000	23400	17000	-	-		
		P	40.5	39.4	37.1	34.2	31.1	27.9	24.5	21.1	17.8	14.6	-	-		

Relating to 20 °C suction gas temperature without liquid subcooling

Motor version -S- (more powerful motor)

Supplementary cooling or reduced suction gas temperature

vap.bock.de



HG semi-hermetic compressors

Performance data

R404A/R507 | 50 Hz

Type		Cooling capacity Q_o [kW]											Power consumption P_e [kW]			
		Evaporating temperature °C														
Cond. temp. °C		7.5	5	0	-5	-10	-15	-20	-25	-30	-35	-40	-45			
		HGX66e/1750-4 HGX66e/1750-4 S	30	Q	195000	180000	151000	126000	104000	84700	68000	53700	41500	31100	22400	15200
P	32.9			32.8	31.9	30.7	28.9	26.9	24.5	22.0	19.3	16.6	14.0	11.4		
40	Q		167000	154000	129000	107000	88000	71400	57100	44800	34200	25200	17600	-		
	P		40.1	39.4	37.6	35.3	32.6	29.7	26.6	23.4	20.2	17.0	13.9	-		
50	Q		138000	127000	106000	87000	71200	57500	45700	35600	27000	19600	-	-		
	P		46.3	45.1	42.3	39.1	35.6	31.9	28.1	24.3	20.5	16.9	-	-		
HGX66e/2070-4 HGX66e/2070-4 S	30	Q	229000	211000	177000	148000	122000	99600	80000	63200	48900	36700	26500	17900		
		P	39.1	38.9	38.0	36.4	34.4	31.9	29.1	26.0	22.8	19.6	16.4	13.4		
	40	Q	196000	180000	151000	126000	104000	83800	67100	52700	40300	29800	20800	-		
		P	47.8	46.9	44.8	42.0	38.8	35.3	31.6	27.7	23.8	20.0	16.4	-		
	50	Q	162000	148000	123000	102000	83400	67400	53700	41900	31800	23100	-	-		
		P	55.4	53.8	50.6	46.7	42.4	37.9	33.3	28.7	24.2	19.9	-	-		
HGX88e/2400-4 HGX88e/2400-4 S	30	Q	272000	251000	209000	175000	144000	118000	94200	74300	57400	43100	31100	21100		
		P	46.0	45.8	44.8	43.0	40.6	37.8	34.6	31.1	27.4	23.7	20.1	16.6		
	40	Q	235000	216000	179000	149000	122000	99000	79100	62000	47400	35100	24500	-		
		P	55.6	54.6	52.7	49.5	45.8	41.8	37.5	33.1	28.6	24.3	20.1	-		
	50	Q	194000	178000	147000	121000	98900	79800	63400	49400	37500	27300	-	-		
		P	63.9	62.2	59.4	54.9	50.0	44.8	39.6	34.3	29.2	24.2	-	-		
HGX88e/2735-4 HGX88e/2735-4 S	30	Q	309000	284000	239000	199000	164000	134000	108000	84700	65400	49100	35400	24000		
		P	52.2	51.9	50.7	48.7	46.1	42.9	39.3	35.5	31.4	27.2	23.0	19.0		
	40	Q	266000	244000	204000	170000	140000	113000	90200	70700	54100	39900	27900	-		
		P	63.3	62.1	59.5	55.9	51.8	47.4	42.6	37.7	32.7	27.8	23.0	-		
	50	Q	220000	202000	168000	139000	113000	91100	72400	56400	42700	31100	-	-		
		P	73.1	71.0	67.0	61.9	56.5	50.8	44.9	39.1	33.3	27.7	-	-		
HGX88e/3235-4 HGX88e/3235-4 S	30	Q	365000	336000	282000	235000	194000	158000	127000	99800	77000	57700	41500	28100		
		P	61.5	61.1	59.8	57.5	54.3	50.6	46.3	41.6	36.8	31.8	26.9	22.1		
	40	Q	314000	288000	241000	200000	165000	133000	107000	83200	63500	46800	32600	-		
		P	74.5	73.1	70.2	66.0	61.1	55.7	50.1	44.2	38.3	32.4	26.8	-		
	50	Q	260000	238000	198000	163000	133000	108000	85100	66200	50100	36400	-	-		
		P	85.9	83.5	79.1	73.0	66.5	59.7	52.7	45.8	38.9	32.2	-	-		

Relating to 20 °C suction gas temperature without liquid subcooling

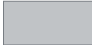
 Motor version -S- (more powerful motor)

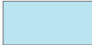
 Supplementary cooling or reduced suction gas temperature

vap.bock.de



HG semi-hermetic compressors

Performance data

R448A | 50 Hz

Type		Cooling capacity Q_0 [kW]											Power consumption P_e [kW]		
		Evaporating temperature °C													
		12.5	10	7.5	5	0	-5	-10	-15	-20	-25	-30	-35	-40	
Cond. temp. °C															
		HGX34e/380-4 HGX34e/380-4 S	30	Q	48800	44600	40600	37000	30000	24500	19800	15700	12300	9440	7070
P	6.17			6.20	6.20	6.17	5.95	5.71	5.38	4.97	4.50	3.98	3.44	2.88	2.33
40	Q		42400	38700	35200	32000	25800	21000	16900	13400	10400	7890	5790	3990	2420
	P		7.82	7.74	7.62	7.48	7.06	6.62	6.09	5.50	4.87	4.20	3.52	2.85	2.19
50	Q		35900	32600	29600	26900	21600	17500	14000	11100	8530	6410	4590	2990	-
	P		9.40	9.19	8.96	8.70	8.08	7.42	6.69	5.92	5.11	4.28	3.46	2.65	-
HGX44e/475-4 HGX44e/475-4 S	30	Q	61800	56500	51700	47100	38600	31500	25400	20200	15800	12200	9150	6660	4620
		P	7.17	7.30	7.37	7.39	7.26	7.00	6.62	6.12	5.54	4.89	4.21	3.53	2.85
	40	Q	54300	49600	45200	41100	33500	27300	21900	17300	13500	10300	7590	5340	3430
		P	9.44	9.40	9.30	9.17	8.77	8.23	7.58	6.84	6.05	5.21	4.37	3.55	2.76
	50	Q	46700	42500	38700	35100	28400	22900	18200	14300	11000	8150	5790	3760	-
		P	11.5	11.3	11.0	10.7	10.0	9.25	8.33	7.34	6.32	5.28	4.26	3.28	-
HGX44e/565-4 HGX44e/565-4 S	30	Q	73700	67500	61700	56200	45900	37500	30300	24200	19000	14700	11200	8160	5710
		P	8.52	8.66	8.75	8.77	8.65	8.35	7.88	7.28	6.58	5.80	4.99	4.16	3.36
	40	Q	64900	59300	54100	49200	40000	32600	26200	20900	16300	12500	9300	6620	4320
		P	11.2	11.1	11.0	10.8	10.4	9.83	9.04	8.15	7.19	6.19	5.18	4.19	3.25
	50	Q	55900	51000	46400	42100	33800	27400	21900	17300	13400	10100	7190	4750	-
		P	13.7	13.4	13.1	12.7	12.1	11.0	9.95	8.75	7.52	6.27	5.04	3.87	-
HGX44e/665-4 HGX44e/665-4 S ¹⁾	30	Q	87000	79500	72600	66000	53700	43800	35300	28100	22000	16900	12700	9210	6350
		P	9.92	10.1	10.2	10.2	10.1	9.81	9.26	8.57	7.75	6.85	5.90	4.93	3.99
	40	Q	76200	69500	63300	57500	46600	37900	30400	24000	18700	14200	10500	7330	4670
		P	13.0	13.0	12.9	12.7	12.2	11.5	10.6	9.58	8.47	7.30	6.12	4.96	3.86
	50	Q	65400	59500	54000	48800	39300	31700	25200	19800	15100	11300	7930	5120	-
		P	16.0	15.7	15.3	14.9	14.1	12.9	11.6	10.2	8.84	7.39	5.97	4.59	-
HGX44e/770-4 HGX44e/770-4 S	30	Q	99500	91100	83200	75900	62600	51100	41300	32900	25800	19900	15100	11000	7650
		P	11.5	11.7	11.8	11.8	11.7	11.3	10.7	9.91	8.96	7.92	6.82	5.71	4.61
	40	Q	87300	79800	72800	66300	54500	44300	35600	28300	22100	16900	12600	8860	5760
		P	15.3	15.2	15.0	14.8	14.1	13.3	12.2	11.0	9.79	8.44	7.08	5.74	4.46
	50	Q	75100	68400	62200	56500	46200	37300	29800	23400	18000	13500	9620	6320	-
		P	18.8	18.4	18.0	17.4	16.3	14.9	13.4	11.8	10.2	8.55	6.90	5.31	-
HGX56e/850-4 HGX56e/850-4 S	30	Q	110000	101000	92100	83900	69000	56300	45500	36300	28600	22100	16700	12300	8560
		P	12.7	12.9	13.0	13.1	12.9	12.5	11.8	10.9	9.87	8.72	7.49	6.25	5.04
	40	Q	96600	88400	80600	73400	60000	48900	39400	31300	24500	18800	14000	9920	6480
		P	16.8	16.7	16.5	16.3	15.6	14.7	13.5	12.2	10.7	9.29	7.78	6.29	4.87
	50	Q	83100	75800	69000	62600	50800	41200	32900	25900	20000	15100	10800	7130	-
		P	20.6	20.2	19.7	19.1	18.0	16.5	14.8	13.1	11.2	9.41	7.58	5.82	-
HGX56e/995-4 HGX56e/995-4 S	30	Q	129000	119000	108000	98500	81100	66400	53800	43000	33900	26200	19800	14400	9760
		P	15.6	15.8	15.9	15.9	15.6	15.0	14.1	13.1	11.8	10.5	9.08	7.60	6.11
	40	Q	113000	104000	94300	86000	70500	57600	46600	37100	29100	22300	16500	11400	6880
		P	20.3	20.1	19.9	19.5	18.7	17.5	16.1	14.6	12.9	11.1	9.34	7.50	5.70
	50	Q	96900	88500	80700	73300	59800	48700	39200	31000	24000	18000	12700	7940	-
		P	24.6	24.2	23.6	22.9	21.5	19.8	17.8	15.8	13.6	11.4	9.22	7.01	-
HGX56e/1155-4 HGX56e/1155-4 S	30	Q	150000	137000	125000	114000	93500	76400	61600	49100	38600	29800	22500	16500	11500
		P	18.0	18.3	18.5	18.5	18.3	17.7	16.7	15.4	13.9	12.3	10.6	8.88	7.17
	40	Q	132000	120000	110000	99500	81300	66200	53200	42300	33000	25200	18800	13300	8620
		P	23.8	23.7	23.4	23.1	22.2	20.8	19.2	17.3	15.3	13.1	11.0	8.93	6.93
	50	Q	113000	103000	93500	84800	68900	55700	44400	34900	26900	20200	14400	9460	-
		P	29.2	28.6	27.9	27.2	25.6	23.4	21.1	18.5	15.9	13.3	10.7	8.26	-
HGX66e/1340-4 HGX66e/1340-4 S	30	Q	160000	146000	133000	133000	109000	88300	71200	56700	44500	34200	25600	18400	-
		P	22.8	22.6	22.4	22.4	21.6	20.5	19.2	17.6	15.8	14.0	12.1	10.1	-
	40	Q	140000	128000	116000	116000	94100	76500	61400	48700	37900	28800	21100	-	-
		P	27.9	27.4	26.8	26.8	25.3	23.6	21.6	19.4	17.1	14.8	12.4	-	-
	50	Q	120000	109000	98600	98600	79700	64400	51400	40400	31000	23100	-	-	-
		P	32.6	31.7	30.8	30.8	28.7	26.2	23.6	20.8	17.9	14.9	-	-	-
HGX66e/1540-4 HGX66e/1540-4 S	30	Q	183000	167000	152000	98500	125000	102000	82100	65500	51600	39800	30000	21700	-
		P	26.2	26.1	25.8	15.9	25.0	23.7	22.2	20.4	18.4	16.3	14.1	11.9	-
	40	Q	161000	146000	133000	86000	109000	88100	71000	56400	44100	33700	24900	-	-
		P	32.2	31.6	31.0	19.5	29.4	27.4	25.1	22.6	20.0	17.3	14.6	-	-
	50	Q	138000	125000	114000	73300	91800	74400	59600	47000	36400	27300	-	-	-
		P	37.9	36.9	35.8	22.9	33.4	30.6	27.5	24.3	21.0	17.7	-	-	-

¹⁾ ASERCOM certified

Relating to 20 °C suction gas temperature without liquid subcooling

Motor version -S- (more powerful motor)

Supplementary cooling or reduced suction gas temperature

vap.bock.de



HG semi-hermetic compressors

Performance data

R448A | 50 Hz

Type		Cooling capacity Q_0 [kW]											Power consumption P_e [kW]		
		Evaporating temperature °C													
		12.5	10	7.5	5	0	-5	-10	-15	-20	-25	-30	-35	-40	
Cond. temp. °C															
		HGX66e/1750-4 HGX66e/1750-4 S	30	Q	207000	189000	173000	98500	143000	117000	94000	75100	59100	45700	34400
P	30.0			29.8	29.5	15.9	28.5	27.1	25.3	23.3	21.1	18.7	16.2	13.7	-
40	Q		182000	166000	151000	86000	124000	101000	81300	64700	50600	38700	28600	-	-
	P		36.8	36.2	35.4	19.5	33.5	31.3	28.7	25.9	22.9	19.9	16.8	-	-
50	Q		156000	142000	129000	73300	106000	85200	68300	54000	41800	31400	-	-	-
	P		43.3	42.2	40.9	22.9	38.1	34.9	31.5	27.9	24.1	20.3	-	-	-
HGX66e/2070-4 HGX66e/2070-4 S	30	Q	244000	223000	203000	98500	167000	137000	111000	88300	69600	53800	40600	29400	-
		P	35.5	35.3	35.0	15.9	33.8	32.1	30.0	27.6	24.9	22.0	19.1	16.1	-
	40	Q	213000	195000	177000	86000	146000	119000	95500	76100	59600	45600	33700	-	-
		P	43.8	43.0	42.1	19.5	39.9	37.2	34.1	30.7	27.1	23.4	19.8	-	-
	50	Q	183000	166000	151000	73300	123000	99900	80200	63400	49200	37000	-	-	-
		P	51.7	50.3	48.7	22.9	45.5	41.6	37.5	33.1	28.5	24.0	-	-	-
HGX88e/2400-4 HGX88e/2400-4 S	30	Q	289000	264000	241000	98500	197000	161000	130000	104000	81700	63200	47600	34500	-
		P	42.0	41.8	41.4	15.9	39.9	38.0	35.6	32.9	29.8	26.5	23.1	19.7	-
	40	Q	255000	232000	211000	86000	172000	140000	113000	89600	70100	53600	39600	-	-
		P	51.1	50.3	49.3	19.5	47.0	43.9	40.3	36.5	32.4	28.2	24.0	-	-
	50	Q	219000	199000	181000	73300	146000	119000	94800	74900	58000	43600	-	-	-
		P	59.8	58.3	56.7	22.9	53.6	49.1	44.3	39.2	34.1	28.9	-	-	-
HGX88e/2735-4 HGX88e/2735-4 S	30	Q	328000	300000	273000	98500	225000	184000	149000	119000	93100	72000	54200	39300	-
		P	47.5	47.2	46.8	15.9	45.3	43.2	40.5	37.4	34.0	30.3	26.5	22.6	-
	40	Q	289000	263000	240000	86000	196000	160000	129000	103000	79900	61100	45100	-	-
		P	58.1	57.1	55.9	19.5	53.2	49.7	45.7	41.4	36.9	32.2	27.4	-	-
	50	Q	248000	226000	205000	73300	167000	136000	109000	85400	66100	49700	-	-	-
		P	68.3	66.5	64.6	22.9	60.5	55.5	50.2	44.6	38.8	33.0	-	-	-
HGX88e/3235-4 HGX88e/3235-4 S	30	Q	387000	354000	323000	98500	265000	217000	175000	140000	110000	84700	63800	46100	-
		P	55.9	55.6	55.1	15.9	53.4	50.9	47.7	44.0	39.9	35.5	31.0	26.4	-
	40	Q	341000	311000	283000	86000	232000	189000	152000	121000	94000	71800	53000	-	-
		P	68.4	67.2	65.8	19.5	62.7	58.6	53.9	48.7	43.3	37.7	32.1	-	-
	50	Q	293000	267000	242000	73300	197000	160000	128000	101000	77700	58300	-	-	-
		P	80.3	78.2	75.9	22.9	71.3	65.4	59.0	52.4	45.5	38.6	-	-	-

R449A | 50 Hz

HGX12P/60-4 S	30	Q	7580	6940	6330	5760	4740	3860	3100	2460	1920	1470	1100	790	544
		P	112	113	114	114	113	108	102	0.955	0.870	0.779	0.686	0.597	0.515
	40	Q	6690	6100	5550	5040	4120	3330	2660	2090	1620	1230	905	644	429
		P	141	140	139	137	131	123	114	103	0.928	0.815	0.704	0.600	0.507
	50	Q	5810	5280	4790	4330	3510	2820	2230	1730	1320	985	711	487	-
		P	173	170	166	161	151	139	126	112	0.985	0.845	0.712	0.588	-
HGX12P/75-4 HGX12P/75-4 S	30	Q	9430	8630	7880	7180	5920	4820	3880	3080	2410	1850	1390	1020	703
		P	138	140	141	141	140	135	127	118	107	0.960	0.844	0.732	0.629
	40	Q	8320	7600	6920	6290	5150	4170	3340	2640	2050	1560	1170	834	564
		P	175	174	173	170	164	154	142	129	115	101	0.874	0.743	0.626
	50	Q	7240	6580	5970	5410	4390	3530	2800	2190	1680	1270	922	641	-
		P	216	213	208	202	191	176	159	141	123	106	0.892	0.736	-
HGX12P/90-4 HGX12P/90-4 S	30	Q	11300	10300	9380	8550	7040	5740	4630	3680	2890	2230	1680	1230	857
		P	167	169	171	171	166	160	151	140	127	113	0.995	0.860	0.736
	40	Q	9890	9030	8230	7480	6130	4970	3990	3160	2460	1880	1410	1020	694
		P	212	212	210	207	195	184	170	154	137	120	103	0.880	0.739
	50	Q	8600	7830	7110	6440	5230	4210	3350	2630	2030	1530	1130	789	-
		P	263	258	253	246	228	210	190	169	148	127	106	0.879	-
HGX12P/110-4 HGX12P/110-4 S	30	Q	13200	12100	11000	10000	8240	6730	5430	4320	3400	2620	1980	1460	1020
		P	195	199	200	201	195	188	178	164	149	133	116	100	0.857
	40	Q	11600	10600	9620	8750	7170	5820	4670	3710	2900	2220	1670	1210	829
		P	251	250	247	244	231	217	200	182	162	141	122	103	0.864
	50	Q	10100	9130	8300	7520	6110	4930	3930	3090	2390	1810	1340	942	-
		P	312	306	299	291	270	249	225	200	175	150	125	103	-
HGX22e/125-4 HGX22e/125-4 S	30	Q	16500	15100	13800	12500	10300	8300	6650	5270	4110	3150	2360	1710	1170
		P	199	205	209	211	211	206	195	181	165	147	129	111	0.956
	40	Q	14400	13100	11900	10800	8820	7130	5700	4490	3480	2640	1950	1360	850
		P	263	263	262	259	250	236	218	198	177	155	134	115	0.984
	50	Q	12300	11100	10100	9110	7420	5960	4740	3710	2850	2130	1530	1010	-
		P	320	314	308	300	282	260	236	210	185	160	136	116	-

HG semi-hermetic compressors

Performance data

R449A 50 Hz		Performance data													
Type	Cond. temp. °C	Cooling capacity Q_0 [kW]												Power consumption P_e [kW]	
		Evaporating temperature °C													
		12.5	10	7.5	5	0	-5	-10	-15	-20	-25	-30	-35	-40	
HGX56e/850-4 HGX56e/850-4 S	30	Q	110000	101000	91600	83500	68600	56100	45300	36200	28500	22000	16700	12300	8550
		P	12.6	12.8	13.0	13.0	12.8	12.4	11.7	10.8	9.84	8.69	7.47	6.23	5.03
	40	Q	96000	87800	80100	72900	59600	48600	39200	31100	24400	18700	13900	9880	6450
		P	16.7	16.6	16.4	16.2	15.5	14.6	13.4	12.1	10.7	9.26	7.75	6.27	4.86
	50	Q	82500	75200	68400	62100	50400	40900	32700	25800	19900	15000	10800	7100	
		P	20.5	20.1	19.6	19.0	17.9	16.4	14.8	13.0	11.2	9.38	7.56	5.80	
HGX56e/995-4 HGX56e/995-4 S	30	Q	129000	118000	108000	98000	80700	66100	53500	42800	33800	26200	19800	14400	9740
		P	15.6	15.7	15.8	15.8	15.5	14.9	14.1	13.0	11.8	10.4	9.06	7.58	6.10
	40	Q	113000	103000	93700	85400	70100	57300	46300	36900	29000	22200	16400	11400	6860
		P	20.2	20.0	19.8	19.4	18.6	17.4	16.1	14.5	12.9	11.1	9.31	7.48	5.68
	50	Q	96100	87800	80000	72800	59400	48400	38900	30800	23900	17900	12600	7900	
		P	24.5	24.0	23.5	22.8	21.4	19.7	17.8	15.7	13.6	11.4	9.19	6.99	
HGX56e/1155-4 HGX56e/1155-4 S	30	Q	149000	136000	125000	114000	93100	76000	61400	48900	38500	29700	22400	16400	11500
		P	17.9	18.2	18.4	18.5	18.3	17.6	16.6	15.4	13.9	12.3	10.5	8.85	7.15
	40	Q	131000	120000	109000	98800	80900	65800	52900	42000	32800	25100	18700	13300	8590
		P	23.7	23.5	23.3	23.0	22.1	20.7	19.1	17.2	15.2	13.1	11.0	8.90	6.91
	50	Q	112000	102000	92800	84200	68400	55300	44100	34700	26700	20000	14400	9420	
		P	29.0	28.5	27.8	27.0	25.4	23.3	21.0	18.5	15.9	13.2	10.7	8.23	
HGX66e/1340-4 HGX66e/1340-4 S	30	Q	159000	145000	132000	114000	108000	87900	71000	56500	44400	34200	25600	18400	
		P	22.7	22.6	22.3	18.5	21.5	20.5	19.1	17.5	15.8	14.0	12.0	10.1	
	40	Q	139000	127000	115000	98800	93600	76100	61100	48500	37700	28700	21000		
		P	27.7	27.2	26.7	23.0	25.2	23.5	21.5	19.4	17.1	14.7	12.3		
	50	Q	119000	108000	97900	84200	79200	64000	51100	40200	30900	23000			
		P	32.5	31.6	30.6	27.0	28.5	26.1	23.5	20.7	17.8	14.9			
HGX66e/1540-4 HGX66e/1540-4 S	30	Q	182000	166000	152000	114000	124000	102000	81800	65300	51400	39700	30000	21700	
		P	26.1	26.0	25.7	18.5	24.9	23.7	22.1	20.3	18.4	16.2	14.1	11.9	
	40	Q	160000	146000	133000	98800	108000	87700	70600	56200	43900	33600	24800		
		P	32.1	31.5	30.8	23.0	29.3	27.3	25.0	22.6	20.0	17.3	14.5		
	50	Q	137000	124000	113000	84200	91200	73900	59200	46800	36200	27200			
		P	37.7	36.7	35.6	27.0	33.3	30.5	27.4	24.3	21.0	17.6			
HGX66e/1750-4 HGX66e/1750-4 S	30	Q	206000	189000	172000	114000	142000	116000	93600	74800	58900	45600	34400	24900	
		P	29.9	29.7	29.4	18.5	28.4	27.0	25.3	23.3	21.0	18.6	16.2	13.7	
	40	Q	181000	165000	150000	98800	124000	101000	81000	64400	50400	38600	28500		
		P	36.7	36.0	35.3	23.0	33.4	31.1	28.6	25.8	22.9	19.8	16.8		
	50	Q	155000	141000	128000	84200	105000	84700	68000	53700	41600	31300			
		P	43.1	42.0	40.7	27.0	38.0	34.8	31.4	27.8	24.1	20.3			
HGX66e/2070-4 HGX66e/2070-4 S	30	Q	242000	222000	202000	114000	167000	136000	111000	88000	69400	53700	40500	29400	
		P	35.3	35.2	34.8	18.5	33.7	32.0	29.9	27.5	24.8	22.0	19.0	16.1	
	40	Q	212000	194000	176000	98800	145000	118000	95100	75800	59400	45500	33600		
		P	43.6	42.8	41.9	23.0	39.7	37.0	33.9	30.6	27.0	23.4	19.7		
	50	Q	181000	165000	150000	84200	123000	99300	79700	63100	49000	36900			
		P	51.4	50.0	48.5	27.0	45.3	41.5	37.3	33.0	28.5	24.0			
HGX88e/2400-4 HGX88e/2400-4 S	30	Q	287000	263000	239000	114000	196000	160000	130000	104000	81500	63000	47500	34500	
		P	41.8	41.6	41.2	18.5	39.7	37.9	35.5	32.8	29.7	26.5	23.1	19.7	
	40	Q	253000	231000	210000	98800	171000	140000	113000	89200	69800	53500	39600		
		P	50.9	50.1	49.1	23.0	46.8	43.7	40.2	36.3	32.3	28.1	23.9		
	50	Q	218000	198000	180000	84200	146000	118000	94300	74500	57800	43500			
		P	59.6	58.0	56.4	27.0	53.3	48.9	44.1	39.1	34.0	28.8			
HGX88e/2735-4 HGX88e/2735-4 S	30	Q	326000	298000	272000	114000	224000	183000	148000	118000	92900	71800	54100	39300	
		P	47.3	47.1	46.6	18.5	45.1	43.0	40.4	37.3	33.9	30.2	26.4	22.6	
	40	Q	287000	262000	238000	98800	195000	159000	128000	102000	79600	60900	45100		
		P	57.9	56.9	55.7	23.0	53.0	49.5	45.6	41.3	36.8	32.1	27.4		
	50	Q	247000	224000	204000	84200	166000	135000	108000	85000	65800	49600			
		P	68.0	66.2	64.3	27.0	60.2	55.3	50.0	44.4	38.7	32.9			
HGX88e/3235-4 HGX88e/3235-4 S	30	Q	385000	352000	321000	114000	264000	216000	175000	139000	110000	84500	63700	46100	
		P	55.7	55.4	54.9	18.5	53.2	50.7	47.6	43.9	39.8	35.5	30.9	26.4	
	40	Q	339000	309000	281000	98800	230000	188000	151000	120000	93700	71600	52900		
		P	68.1	66.9	65.6	23.0	62.5	58.4	53.7	48.6	43.2	37.6	32.0		
	50	Q	291000	265000	240000	84200	196000	159000	127000	100000	77400	58100			
		P	79.9	77.8	75.5	27.0	71.0	65.1	58.8	52.2	45.4	38.5			

Relating to 20 °C suction gas temperature without liquid subcooling

Motor version -S- (more powerful motor)

Supplementary cooling or reduced suction gas temperature

vap.bock.de



HG semi-hermetic compressors

Performance data

R407A | 50 Hz

Type		Cooling capacity Q_0 [kW]											Power consumption P_e [kW]	
		Evaporating temperature °C												
		10	7,5	5	0	-5	-10	-15	-20	-25	-30	-35	-40	
HGX34e/380-4 HGX34e/380-4 S	30	Q	43800	39900	36200	29300	23900	19200	15200	11900	9030	6720	4830	3290
		P	6.24	6.23	6.19	5.93	5.68	5.33	4.91	4.42	3.89	3.34	2.79	2.25
	40	Q	37900	34500	31300	25300	20500	16500	13000	10100	7560	5510	3790	-
		P	7.77	7.64	7.49	7.05	6.59	6.04	5.43	4.77	4.09	3.40	2.72	-
	50	Q	32000	29100	26300	21200	17200	13700	10700	8180	6060	-	-	-
		P	9.22	8.97	8.70	8.08	7.38	6.62	5.81	4.97	4.12	-	-	-
HGX44e/475-4 HGX44e/475-4 S	30	Q	56800	51900	47300	38700	31500	25300	20000	15600	11900	8840	6390	4420
		P	7.37	7.47	7.51	7.40	7.15	6.75	6.22	5.61	4.95	4.26	3.57	2.92
	40	Q	49700	45300	41200	33500	27100	21700	17100	13200	9960	7310	5130	-
		P	9.41	9.35	9.23	8.86	8.33	7.67	6.91	6.09	5.24	4.39	3.57	-
	50	Q	42500	38600	35000	28300	22800	18100	14100	10800	8040	-	-	-
		P	11.2	11.0	10.7	10.1	9.34	8.41	7.42	6.39	5.35	-	-	-
HGX44e/565-4 HGX44e/565-4 S	30	Q	67800	61900	56400	46000	37500	30200	24000	18800	14400	10800	7830	5480
		P	8.75	8.87	8.92	8.84	8.53	8.04	7.41	6.67	5.87	5.04	4.22	3.44
	40	Q	59400	54200	49300	39900	32400	26000	20600	16000	12200	8970	6380	-
		P	11.1	11.1	10.9	10.6	9.95	9.15	8.24	7.25	6.22	5.20	4.22	-
	50	Q	51000	46300	42000	33700	27300	21800	17100	13200	9890	-	-	-
		P	13.4	13.1	12.8	12.1	11.1	10.0	8.85	7.60	6.35	-	-	-
HGX44e/665-4 HGX44e/665-4 S ¹⁾	30	Q	79000	72100	65700	53800	43800	35200	27800	21600	16500	12300	8820	6070
		P	10.2	10.3	10.4	10.3	10.0	9.45	8.71	7.86	6.93	5.96	5.00	4.09
	40	Q	69000	62900	57100	46500	37700	30100	23700	18300	13800	10100	7030	-
		P	13.1	13.0	12.8	12.4	11.6	10.7	9.68	8.53	7.34	6.15	5.00	-
	50	Q	58900	53500	48500	39200	31500	25000	19500	14900	11100	-	-	-
		P	15.7	15.4	15.0	14.2	13.0	11.7	10.3	8.94	7.49	-	-	-
HGX44e/770-4 HGX44e/770-4 S	30	Q	91500	83600	76200	62700	51100	41100	32600	25400	19500	14600	10600	7340
		P	11.8	12.0	12.0	11.9	11.5	10.9	10.0	9.09	8.01	6.89	5.78	4.73
	40	Q	80000	72900	66300	54400	44100	35300	27900	21600	16400	12100	8530	-
		P	15.2	15.1	14.9	14.3	13.4	12.4	11.1	9.86	8.49	7.11	5.78	-
	50	Q	68400	62200	56400	46000	37100	29500	23100	17800	13300	-	-	-
		P	18.3	18.0	17.5	16.4	15.1	13.6	12.0	10.3	8.66	-	-	-
HGX56e/850-4 HGX56e/850-4 S	30	Q	99300	90700	82500	69100	56300	45400	36000	28100	21600	16200	11800	8220
		P	13.0	13.2	13.2	13.2	12.7	12.0	11.1	10.0	8.82	7.57	6.33	5.16
	40	Q	86800	79000	71800	59900	48700	39000	30900	24000	18200	13500	9570	-
		P	16.7	16.6	16.4	15.8	14.8	13.7	12.3	10.8	9.35	7.82	6.34	-
	50	Q	74300	67500	61100	50700	40900	32700	25700	19800	14900	-	-	-
		P	20.1	19.7	19.2	18.1	16.6	15.0	13.2	11.4	9.54	-	-	-
HGX56e/995-4 HGX56e/995-4 S	30	Q	116000	106000	96400	79600	65300	52900	42200	33100	25500	19000	13600	9140
		P	15.6	15.6	15.6	15.2	14.6	13.8	12.7	11.5	10.2	8.81	7.32	5.81
	40	Q	103000	93500	85300	70000	57100	45900	36400	28300	21400	15600	10700	-
		P	19.9	19.6	19.2	18.3	17.1	15.7	14.2	12.5	10.7	8.90	7.02	-
	50	Q	88600	80700	73300	59700	48300	38500	30100	23100	17100	-	-	-
		P	23.8	23.2	22.5	21.0	19.2	17.3	15.2	13.0	10.8	-	-	-
HGX56e/1155-4 HGX56e/1155-4 S	30	Q	138000	126000	115000	93400	75800	60800	48000	37300	28400	21100	15200	10500
		P	18.6	18.9	19.0	18.8	18.2	17.2	15.9	14.4	12.7	11.1	9.43	7.86
	40	Q	121000	110000	99300	80800	65400	52200	41000	31600	23900	17500	12200	-
		P	23.9	23.7	23.4	22.6	21.2	19.6	17.7	15.7	13.6	11.5	9.61	-
	50	Q	103000	93400	84500	68300	54900	43500	33900	25900	19200	-	-	-
		P	28.7	28.1	27.4	25.9	23.9	21.6	19.1	16.6	14.1	-	-	-
HGX66e/1340-4 HGX66e/1340-4 S	30	Q	156000	142000	129000	105000	85200	68400	54200	42300	32400	24100	17200	11200
		P	22.3	22.2	22.0	21.2	20.1	18.8	17.3	15.5	13.6	11.7	9.77	7.81
	40	Q	136000	124000	113000	90900	73600	58900	46500	36000	27200	19700	-	-
		P	27.6	27.0	26.4	25.0	23.2	21.2	19.0	16.7	14.3	11.9	-	-
	50	Q	117000	106000	95500	76900	61900	49300	38600	29500	21700	-	-	-
		P	32.4	31.5	30.5	28.3	25.8	23.1	20.3	17.3	14.4	-	-	-
HGX66e/1540-4 HGX66e/1540-4 S	30	Q	179000	163000	148000	121000	97900	78800	62600	49100	37700	28300	20300	13400
		P	25.7	25.5	25.3	24.5	23.3	21.8	20.0	18.0	15.9	13.7	11.4	9.24
	40	Q	156000	142000	129000	105000	84800	68000	53900	42000	31900	23300	-	-
		P	31.9	31.3	30.6	29.0	27.0	24.7	22.2	19.5	16.8	14.0	-	-
	50	Q	134000	122000	110000	88600	71600	57200	44900	34600	25700	-	-	-
		P	37.7	36.6	35.4	33.0	30.2	27.1	23.8	20.4	17.0	-	-	-

¹⁾ ASERCOM certified

Relating to 20 °C suction gas temperature without liquid subcooling

Motor version -S- (more powerful motor)

Supplementary cooling or reduced suction gas temperature

vap.bock.de



HG semi-hermetic compressors

Performance data

R407A 50 Hz														
Type		Cooling capacity Q_0 [W]											Power consumption P_e [kW]	
		Evaporating temperature °C												
Cond. temp. °C		10	7,5	5	0	-5	-10	-15	-20	-25	-30	-35	-40	
HGX66e/1750-4	30	Q	203000	185000	168000	138000	113000	90200	71700	56200	43300	32400	23300	15400
		P	29.4	29.2	28.9	27.9	26.6	24.9	22.9	20.6	18.2	15.7	13.2	10.7
	40	Q	177000	161000	147000	120000	97100	78000	61800	48200	36700	26800	-	-
HGX66e/1750-4 S	30	Q	152000	138000	125000	102000	82000	65600	51600	39800	29600	-	-	-
		P	43.0	41.8	40.5	37.7	34.4	30.9	27.3	23.4	19.6	-	-	-
	40	Q	177000	161000	147000	120000	97100	78000	61800	48200	36700	26800	-	-
HGX66e/2070-4	30	Q	239000	218000	198000	162000	132000	107000	84400	66200	51000	38200	27500	18200
		P	34.8	34.6	34.3	33.1	31.5	29.5	27.0	24.4	21.5	18.5	15.5	12.5
	40	Q	208000	189000	172000	141000	114000	91600	72700	56700	43200	31600	-	-
HGX66e/2070-4 S	30	Q	178000	161000	146000	119000	96100	77000	60700	46800	34800	-	-	-
		P	51.3	49.9	48.3	45.0	41.0	36.8	32.3	27.7	23.1	-	-	-
	40	Q	208000	189000	172000	141000	114000	91600	72700	56700	43200	31600	-	-
HGX88e/2400-4	30	Q	283000	258000	234000	191000	155000	125000	99200	77800	59900	44900	32300	21400
		P	41.2	41.0	40.6	39.1	37.3	35.0	32.2	29.2	25.9	22.5	19.0	15.5
	40	Q	248000	226000	205000	166000	135000	108000	85600	66700	50800	37200	-	-
HGX88e/2400-4 S	30	Q	213000	194000	175000	141000	114000	91000	71600	55200	41100	-	-	-
		P	59.5	57.9	56.2	52.9	48.4	43.5	38.4	33.2	27.9	-	-	-
	40	Q	248000	226000	205000	166000	135000	108000	85600	66700	50800	37200	-	-
HGX88e/2735-4	30	Q	321000	293000	266000	218000	177000	143000	114000	88600	68200	51100	36700	24300
		P	46.6	46.4	45.9	44.4	42.4	39.8	36.7	33.3	29.6	25.7	21.7	17.7
	40	Q	281000	256000	232000	190000	154000	124000	97600	76100	57900	42400	-	-
HGX88e/2735-4 S	30	Q	242000	219000	199000	161000	131000	104000	81700	62900	46800	-	-	-
		P	67.9	66.0	64.0	59.8	54.7	49.3	43.6	37.8	31.8	-	-	-
	40	Q	281000	256000	232000	190000	154000	124000	97600	76100	57900	42400	-	-
HGX88e/3235-4	30	Q	379000	346000	314000	257000	209000	168000	134000	105000	80300	60100	43100	28500
		P	54.9	54.6	54.1	52.4	49.9	46.9	43.2	39.1	34.7	30.1	25.4	20.7
	40	Q	332000	302000	274000	224000	181000	146000	115000	89500	68000	49700	-	-
HGX88e/3235-4 S	30	Q	285000	259000	234000	190000	154000	123000	96100	73900	54900	-	-	-
		P	79.8	77.6	75.2	70.5	64.5	58.0	51.2	44.3	37.2	-	-	-
	40	Q	332000	302000	274000	224000	181000	146000	115000	89500	68000	49700	-	-

Relating to 20 °C suction gas temperature without liquid subcooling

Motor version -S- (more powerful motor)

Supplementary cooling or reduced suction gas temperature

vap.bock.de



HG semi-hermetic compressors

Performance data

R407C 50 Hz												
Type		Cooling capacity Q_o [W]						Power consumption P_e [kW]				
		Evaporating temperature °C										
		12.5	10	7.5	5	0	-5	-10	-15	-20	-25	
Cond. temp. °C												
HGX12P/60-4 S	30	Q	6780	6180	5610	5080	4140	3330	2650	2080	1610	1230
		P	0.88	0.90	0.92	0.92	0.91	0.88	0.82	0.76	0.69	0.62
	40	Q	5870	5340	4840	4380	3560	2860	2270	1780	1360	1020
		P	1.16	1.16	1.15	1.13	1.08	1.01	0.92	0.83	0.74	0.66
	50	Q	5010	4550	4120	3720	3020	2420	1920	1490	1130	827
		P	1.41	1.39	1.35	1.31	1.22	1.12	1.00	0.90	0.79	0.69
HGX12P/75-4 HGX12P/75-4 S	30	Q	8740	7960	7230	6550	5340	4300	3420	2680	2080	1580
		P	1.12	1.16	1.18	1.18	1.17	1.13	1.06	0.98	0.89	0.79
	40	Q	7560	6880	6240	5650	4590	3690	2920	2290	1760	1320
		P	1.50	1.49	1.48	1.46	1.39	1.30	1.19	1.07	0.96	0.84
	50	Q	6450	5860	5310	4800	3890	3120	2470	1920	1460	1070
		P	1.82	1.79	1.74	1.69	1.58	1.44	1.29	1.15	1.01	0.89
HGX12P/90-4 HGX12P/90-4 S	30	Q	10500	9490	8620	7810	6360	5120	4080	3200	2480	1890
		P	1.34	1.38	1.40	1.41	1.40	1.34	1.26	1.16	1.05	0.95
	40	Q	9020	8200	7440	6730	5470	4400	3490	2730	2090	1570
		P	1.79	1.78	1.77	1.74	1.66	1.55	1.42	1.28	1.13	1.00
	50	Q	7690	6990	6330	5720	4640	3720	2940	2290	1740	1280
		P	2.17	2.13	2.08	2.02	1.88	1.72	1.55	1.37	1.21	1.06
HGX12P/110-4 HGX12P/110-4 S	30	Q	12300	11200	10200	9180	7480	6020	4790	3760	2910	2220
		P	1.58	1.62	1.65	1.66	1.64	1.58	1.48	1.37	1.24	1.11
	40	Q	10600	9640	8750	7910	6430	5170	4100	3200	2460	1850
		P	2.10	2.10	2.08	2.05	1.95	1.82	1.67	1.50	1.33	1.18
	50	Q	9040	8210	7440	6730	5460	4370	3460	2690	2040	1500
		P	2.56	2.51	2.45	2.38	2.21	2.02	1.82	1.61	1.42	1.25
HGX22e/125-4 HGX22e/125-4 S	30	Q	14400	13100	11900	10800	8790	7070	5630	4420	3420	2600
		P	1.78	1.82	1.85	1.87	1.85	1.78	1.67	1.53	1.39	1.25
	40	Q	12500	11400	10300	9300	7560	6060	4800	3760	2890	2160
		P	2.36	2.35	2.33	2.30	2.19	2.04	1.87	1.68	1.5	1.32
	50	Q	10700	9640	8740	7910	6410	5120	4050	3150	2400	1760
		P	2.87	2.81	2.75	2.67	2.48	2.27	2.04	1.81	1.59	1.40
HHGX22e/160-4 HGX22e/160-4 S	30	Q	17600	16000	14500	13200	10700	8730	6950	5470	4240	3230
		P	2.18	2.24	2.28	2.30	2.27	2.30	2.16	1.99	1.79	1.61
	40	Q	15200	13800	12500	11300	9180	7500	5950	4650	3580	2680
		P	2.90	2.90	2.87	2.83	2.69	2.64	2.42	2.18	1.94	1.72
	50	Q	12900	11700	10700	9590	7780	6350	5020	3900	2970	2180
		P	3.53	3.46	3.38	3.28	3.05	2.93	2.64	2.34	2.06	1.81
HGX22e/190-4 HGX22e/190-4 S	30	Q	21800	19900	18100	16400	13300	10800	8550	6700	5180	3960
		P	2.67	2.74	2.79	2.81	2.78	2.83	2.65	2.44	2.20	1.98
	40	Q	18900	17200	15600	14100	11500	9220	7310	5710	4390	3290
		P	3.54	3.54	3.51	3.46	3.29	3.25	2.97	2.68	2.38	2.10
	50	Q	16100	14600	13300	12000	9700	7790	6170	4810	3650	2670
		P	4.31	4.23	4.13	4.01	3.73	3.60	3.24	2.87	2.53	2.22
HGX34e/215-4 HGX34e/215-4 S	30	Q	25600	23300	21100	19100	15600	12200	9720	7650	5910	4480
		P	3.45	3.49	3.50	3.48	3.39	3.16	2.94	2.67	2.38	2.09
	40	Q	22400	20300	18400	16600	13400	10400	8190	6410	4920	3700
		P	4.38	4.33	4.26	4.17	3.94	3.60	3.25	2.89	2.52	2.17
	50	Q	19100	17300	15600	14100	11300	8590	6820	5330	4100	3100
		P	5.19	5.06	4.91	4.75	4.39	3.98	3.54	3.09	2.66	2.27
HGX34e/255-4 HGX34e/255-4 S	30	Q	29600	27000	24600	22300	18300	14500	11500	9040	7030	5300
		P	4.30	4.30	4.28	4.23	4.08	3.84	3.54	3.20	2.85	2.48
	40	Q	26000	23600	21500	19500	15800	12300	9730	7660	5940	4430
		P	5.33	5.24	5.13	5.00	4.71	4.38	3.94	3.50	3.06	2.63
	50	Q	22200	20200	18300	16500	13400	10200	8080	6420	5050	3820
		P	6.25	6.08	5.89	5.69	5.25	4.83	4.29	3.76	3.26	2.79
HGX34e/315-4 HGX34e/315-4 S	30	Q	35900	32700	29800	27000	22100	17600	14100	11100	8590	6550
		P	4.95	5.00	5.01	4.99	4.86	4.69	4.34	3.96	3.55	3.11
	40	Q	31300	28500	25900	23500	19200	15100	12000	9420	7260	5500
		P	6.32	6.25	6.16	6.04	5.72	5.33	4.85	4.33	3.80	3.27
	50	Q	26800	24300	22100	20000	16200	12800	10200	7910	6060	4550
		P	7.63	7.45	7.24	7.02	6.50	5.87	5.25	4.63	3.99	3.37

Relating to 20 °C suction gas temperature without liquid subcooling

Motor version -S- (more powerful motor)

Supplementary cooling or reduced suction gas temperature

vap.bock.de 

HG semi-hermetic compressors

Performance data

R407C | 50 Hz

Type		Cooling capacity Q_o [W]									Power consumption P_e [kW]	
		Evaporating temperature °C										
		12.5	10	7.5	5	0	-5	-10	-15	-20	-25	
Cond. temp. °C	Q P											
		HGX34e/380-4 HGX34e/380-4 S	30	Q	43500	39600	36000	32700	26700	21600	17500	13900
P	6.40			6.35	6.27	6.17	5.93	5.84	5.38	4.91	4.42	3.90
40	Q		38000	34600	31400	28400	23200	18700	15100	12000	9320	7140
	P		7.95	7.78	7.59	7.39	6.94	6.71	6.08	5.45	4.82	4.18
50	Q		32200	29300	26500	24000	19600	15800	12800	10100	7900	6070
	P		9.52	9.23	8.92	8.60	7.93	7.49	6.69	5.91	5.13	4.36
HGX44e/475-4 HGX44e/475-4 S	30	Q	56600	51700	47100	42800	35200	28500	22900	18100	14100	10700
		P	7.20	7.25	7.25	7.21	7.03	6.66	6.24	5.73	5.18	4.59
	40	Q	50200	45800	41700	37800	30900	24900	19900	15600	12000	8850
		P	9.13	9.03	8.89	8.72	8.28	7.69	7.05	6.35	5.61	4.87
	50	Q	43600	39700	36000	32600	26500	21200	16800	13100	9850	7100
		P	10.80	10.50	10.30	10.00	9.33	8.54	7.69	6.80	5.90	5.02
HGX44e/565-4 HGX44e/565-4 S	30	Q	67400	61600	56200	51100	42000	33900	27300	21700	17000	12900
		P	8.54	8.60	8.61	8.56	8.34	7.93	7.42	6.81	6.14	5.44
	40	Q	60000	54700	49800	45200	37000	29700	23800	18700	14500	10800
		P	10.80	10.70	10.50	10.30	9.83	9.18	8.40	7.55	6.67	5.78
	50	Q	52200	47500	43100	39000	31800	25300	20100	15700	12000	8650
		P	12.80	12.50	12.20	11.80	11.00	10.20	9.18	8.10	7.01	5.95
HGX44e/665-4 HGX44e/665-4 S ¹⁾	30	Q	78700	71900	65500	59600	48900	40000	32200	25500	19800	15000
		P	10.00	10.00	10.00	10.00	9.76	9.23	8.65	7.95	7.17	6.36
	40	Q	69800	63600	57900	52500	42900	34900	27900	21900	16800	12400
		P	12.70	12.50	12.30	12.10	11.50	10.60	9.77	8.80	7.78	6.75
	50	Q	60600	55100	49900	45200	36700	29700	23500	18300	13800	9890
		P	15.10	14.70	14.40	13.90	13.00	11.80	10.60	9.43	8.18	6.96
HGX44e/770-4 HGX44e/770-4 S	30	Q	92000	84000	76600	69600	57100	46300	37100	29300	22700	17000
		P	11.60	11.70	11.70	11.60	11.30	10.80	10.00	9.22	8.26	7.23
	40	Q	81400	74200	67400	61200	49900	40300	32000	25000	19000	13900
		P	14.80	14.70	14.40	14.10	13.30	12.40	11.30	10.00	8.82	7.51
	50	Q	70400	64000	58000	52400	42500	34000	26800	20600	15400	10800
		P	17.60	17.20	16.70	16.20	15.00	13.60	12.10	10.60	9.06	7.49
HGX56e/850-4 HGX56e/850-4 S	30	Q	101000	92000	83900	76300	62800	50900	41000	32600	25400	19300
		P	12.7	12.8	12.8	12.7	12.4	11.8	11.1	10.2	9.23	8.17
	40	Q	89400	81500	74200	67400	55200	44500	35700	28100	21700	16100
		P	16.2	16.0	15.8	15.4	14.7	13.7	12.5	11.3	10.0	8.68
	50	Q	77600	70600	64100	58100	47300	38000	30200	23600	18000	13000
		P	19.3	18.8	18.3	17.8	16.5	15.2	13.7	12.1	10.5	8.93
HGX56e/995-4 HGX56e/995-4 S	30	Q	121000	111000	101000	91500	75400	61200	49300	39100	30500	23200
		P	14.3	14.5	14.6	14.6	14.4	13.8	13.0	11.9	10.7	9.45
	40	Q	107000	96900	88300	80300	65900	53300	42700	33600	25900	19400
		P	18.8	18.7	18.5	18.2	17.3	16.2	14.8	13.3	11.6	10.0
	50	Q	92100	83900	76400	69300	56700	45600	36300	28400	21600	15800
		P	23.1	22.6	22.0	21.4	19.9	18.2	16.3	14.3	12.2	10.2
HGX56e/1155-4 HGX56e/1155-4 S	30	Q	139000	127000	115000	105000	85600	69200	55500	43800	33900	25400
		P	18.2	18.3	18.3	18.2	17.7	16.9	15.7	14.4	12.8	11.2
	40	Q	123000	112000	102000	91800	74900	60100	47800	37300	28400	20700
		P	23.1	22.9	22.5	22.0	20.8	19.4	17.6	15.7	13.7	11.7
	50	Q	106000	96100	87100	78700	63800	50800	40000	30800	23000	16100
		P	27.4	26.8	26.0	25.2	23.4	21.3	19.0	16.6	14.1	11.6
HGX66e/1340-4 HGX66e/1340-4 S	30	Q	164000	149000	136000	123000	101000	80800	64600	51000	39500	29900
		P	21.3	21.1	20.9	20.6	19.8	18.8	17.6	16.1	14.5	12.6
	40	Q	144000	131000	119000	108000	87800	70300	56000	43900	33700	25100
		P	26.4	25.9	25.4	24.8	23.4	21.7	19.9	17.9	15.6	13.2
	50	Q	124000	113000	102000	92200	74900	59600	47300	36800	27900	20300
		P	31.3	30.5	29.6	28.6	26.5	24.2	21.7	19.0	16.1	13.1
HGX66e/1540-4 HGX66e/1540-4 S	30	Q	187000	171000	156000	141000	116000	92900	74500	59000	45900	34800
		P	24.4	24.3	24.0	23.7	22.8	21.7	20.3	18.7	16.8	14.7
	40	Q	165000	150000	137000	124000	102000	81000	64800	51000	39300	29400
		P	30.5	29.9	29.3	28.6	27.0	25.2	23.1	20.8	18.3	15.5
	50	Q	142000	129000	118000	107000	86400	69000	54900	43000	32800	24000
		P	36.3	35.3	34.3	33.2	30.8	28.2	25.4	22.3	19.0	15.5

¹⁾ ASERCOM certified

Relating to 20 °C suction gas temperature without liquid subcooling

Motor version -S- (more powerful motor)

Supplementary cooling or reduced suction gas temperature

vap.bock.de



HG semi-hermetic compressors

Performance data

R407C 50 Hz												
Type		Cooling capacity Q_o [kW]					Power consumption P_e [kW]					
		Evaporating temperature °C										
Cond. temp. °C		12.5	10	7.5	5	0	-5	-10	-15	-20	-25	
HGX66e/1750-4 HGX66e/1750-4 S	30	Q	212000	194000	177000	160000	132000	107000	85300	67500	52500	39900
		P	28.0	27.8	27.5	27.1	26.2	24.8	23.2	21.4	19.3	16.9
	40	Q	187000	171000	155000	141000	115000	92800	74200	58500	45100	33800
		P	34.9	34.2	33.5	32.7	31.0	28.8	26.4	23.8	21.0	17.8
	50	Q	161000	147000	133000	121000	98100	79100	63000	49400	37700	27600
		P	41.5	40.4	39.2	38.0	35.3	32.3	29.0	25.5	21.8	17.8
HGX66e/2070-4 HGX66e/2070-4 S	30	Q	250000	228000	208000	189000	155000	126000	101000	79500	61900	47100
		P	33.1	32.8	32.5	32.0	30.9	29.3	27.5	25.3	22.8	19.9
	40	Q	220000	200000	182000	165000	135000	109000	87300	68800	53200	39800
		P	41.4	40.6	39.8	38.8	36.7	34.2	31.3	28.2	24.8	21.0
	50	Q	189000	172000	156000	142000	116000	92800	74000	58100	44400	32500
		P	49.5	48.1	46.7	45.2	41.9	38.4	34.4	30.2	25.7	21.0
HGX88e/2400-4 HGX88e/2400-4 S	30	Q	296000	270000	246000	223000	183000	147000	118000	93300	72600	55200
		P	39.3	39.0	38.6	38.1	36.9	34.8	32.7	30.2	27.3	24.1
	40	Q	261000	238000	217000	196000	161000	129000	103000	81000	62500	46800
		P	48.5	47.7	46.7	45.7	43.3	40.4	37.2	33.6	29.6	25.4
	50	Q	226000	206000	187000	169000	138000	110000	87400	68500	52300	38400
		P	57.5	56.0	54.4	52.7	49.1	45.3	40.8	36.0	30.9	25.5
HGX88e/2735-4 HGX88e/2735-4 S	30	Q	336000	306000	279000	253000	208000	168000	135000	107000	82700	62900
		P	44.4	44.1	43.6	43.1	41.7	39.6	37.3	34.5	31.2	27.5
	40	Q	296000	270000	246000	223000	182000	147000	118000	92300	71200	53300
		P	55.1	54.1	53.0	51.8	49.1	45.9	42.3	38.2	33.8	29.1
	50	Q	257000	233000	212000	192000	156000	126000	99700	78100	59600	43700
		P	65.5	63.8	61.9	60.0	55.8	51.3	46.3	40.9	35.2	29.2
HGX88e/3235-4 HGX88e/3235-4 S	30	Q	396000	362000	329000	299000	245000	198000	159000	126000	97500	74000
		P	52.3	51.9	51.4	50.8	49.1	46.7	43.9	40.5	36.7	32.3
	40	Q	350000	319000	290000	263000	215000	173000	139000	109000	83800	62700
		P	64.9	63.7	62.4	61.0	57.8	54.0	49.7	44.9	39.7	34.0
	50	Q	303000	275000	250000	226000	184000	148000	118000	91800	70000	51300
		P	77.1	75.0	72.8	70.5	65.6	60.4	54.4	48.0	41.2	34.1

Relating to 20 °C suction gas temperature without liquid subcooling

 Motor version -S- (more powerful motor)

 Supplementary cooling or reduced suction gas temperature

vap.bock.de



HG semi-hermetic compressors

Performance data

R407F | 50 Hz

Type		Cooling capacity Q_0 [kW]											Power consumption P_e [kW]	
		Evaporating temperature °C												
		10	7,5	5	0	-5	-10	-15	-20	-25	-30	-35	-40	
HGX34e/380-4 HGX34e/380-4 S	30	Q	45700	41600	37800	30700	25000	20100	15900	12400	9460	7040	5030	3320
		P	6.39	6.39	6.36	6.15	5.88	5.53	5.09	4.60	4.07	3.51	2.94	2.38
	40	Q	39900	36200	32900	26500	21500	17200	13600	10600	8000	5870	4050	
		P	8.05	7.93	7.77	7.34	6.85	6.29	5.67	5.00	4.31	3.61	2.92	
	50	Q	33800	30700	27800	22300	18000	14400	11300	8760	6630			
		P	9.65	9.39	9.10	8.45	7.73	6.94	6.11	5.26	4.40			
HGX44e/475-4 HGX44e/475-4 S	30	Q	58200	53100	48400	39600	32300	26000	20600	16100	12400	9210	6640	4520
		P	7.56	7.67	7.73	7.62	7.37	6.98	6.45	5.84	5.15	4.43	3.71	3.00
	40	Q	51000	46500	42400	34500	28100	22600	17900	13900	10500	7620	5210	
		P	9.81	9.74	9.63	9.22	8.67	7.99	7.21	6.36	5.46	4.55	3.65	
	50	Q	43900	40000	36300	29400	23900	19100	15000	11500	8460			
		P	11.8	11.6	11.3	10.6	9.78	8.81	7.76	6.67	5.55			
HGX44e/565-4 HGX44e/565-4 S	30	Q	69400	63400	57800	47100	38500	31000	24700	19400	14900	11200	8120	5600
		P	9.05	9.18	9.24	9.13	8.84	8.36	7.73	6.99	6.16	5.30	4.42	3.57
	40	Q	61000	55700	50700	41100	33500	27000	21500	16700	12800	9330	6460	
		P	11.7	11.6	11.5	11.1	10.4	9.61	8.66	7.63	6.54	5.44	4.36	
	50	Q	52600	47900	43600	35100	28600	22900	18100	14000	10400			
		P	14.1	13.8	13.5	12.8	11.8	10.6	9.35	8.02	6.66			
HGX44e/665-4 HGX44e/665-4 S ¹⁾	30	Q	81800	74700	68000	55700	45400	36500	29000	22600	17300	12900	9260	6270
		P	10.5	10.6	10.7	10.6	10.2	9.72	9.00	8.15	7.20	6.20	5.18	4.19
	40	Q	71600	65300	59400	48500	39400	31600	25000	19400	14700	10700	7220	
		P	13.6	13.5	13.4	12.8	12.0	11.1	10.0	8.88	7.63	6.36	5.11	
	50	Q	61600	56000	50900	41300	33400	26700	20900	16000	11800			
		P	16.5	16.2	15.8	14.8	13.6	12.3	10.8	9.33	7.78			
HGX44e/770-4 HGX44e/770-4 S	30	Q	93600	85500	77900	64300	52400	42200	33600	26300	20200	15100	10900	7350
		P	12.1	12.3	12.4	12.3	11.9	11.3	10.4	9.50	8.42	7.29	6.16	5.08
	40	Q	82000	74900	68200	56100	45700	36700	29100	22600	17100	12500	8480	
		P	15.8	15.7	15.5	14.9	14.0	12.9	11.7	10.3	8.99	7.58	6.20	
	50	Q	70500	64300	58400	47900	38900	31100	24400	18700	13900			
		P	19.2	18.8	18.3	17.2	15.8	14.3	12.7	11.0	9.27			
HGX56e/850-4 HGX56e/850-4 S	30	Q	104000	94600	86300	70700	57800	46600	37100	29100	22400	16800	12200	8390
		P	13.5	13.7	13.8	13.6	13.2	12.5	11.6	10.4	9.26	7.96	6.64	5.36
	40	Q	90800	82900	75500	61800	50400	40600	32200	25100	19100	14100	9680	
		P	17.5	17.4	17.2	16.5	15.5	14.3	12.9	11.4	9.82	8.18	6.55	
	50	Q	78100	71200	64700	52700	42900	34400	27200	21000	15600			
		P	21.3	20.8	20.3	19.1	17.5	15.8	13.9	12.0	10.0			
HGX56e/995-4 HGX56e/995-4 S	30	Q	122000	112000	102000	83700	68600	55500	44200	34600	26600	19800	14100	9420
		P	16.5	16.5	16.4	16.0	15.4	14.5	13.4	12.1	10.7	9.23	7.65	6.04
	40	Q	108000	98400	89700	73600	60000	48200	38100	29600	22300	16200	11000	
		P	20.9	20.6	20.2	19.3	18.0	16.6	15.0	13.2	11.3	9.38	7.36	
	50	Q	93700	85400	77600	63100	51100	40700	31900	24300	17900			
		P	25.1	24.4	23.8	22.2	20.4	18.4	16.2	13.9	11.4			
HGX56e/1155-4 HGX56e/1155-4 S	30	Q	141000	129000	117000	96000	78300	63100	50200	39300	30100	22500	16300	11100
		P	18.9	19.2	19.3	19.2	18.6	17.6	16.3	14.8	13.1	11.3	9.59	7.89
	40	Q	124000	113000	103000	83800	68200	54900	43500	33800	25600	18700	12700	
		P	24.6	24.4	24.1	23.4	22.0	20.3	18.3	16.2	14.0	11.8	9.65	
	50	Q	106000	96600	87800	71500	58000	46400	36500	28000	20700			
		P	29.8	29.2	28.5	27.0	24.9	22.5	19.9	17.2	14.4			
HGX66e/1340-4 HGX66e/1340-4 S	30	Q	164000	149000	136000	111000	89600	71900	56900	44300	33800	25000		
		P	23.1	23.0	22.8	22.1	21.0	19.6	17.9	16.1	14.2	12.2		
	40	Q	144000	131000	119000	96300	78000	62400	49100	38000	28700			
		P	29.0	28.5	27.8	26.3	24.4	22.3	19.9	17.5	15.0			
	50	Q	124000	113000	102000	82200	66200	52600	41100	31500				
		P	34.5	33.4	32.3	30.0	27.3	24.4	21.4	18.3				
HGX66e/1540-4 HGX66e/1540-4 S	30	Q	187000	171000	156000	127000	103000	82900	65800	51400	39300	29300		
		P	26.6	26.5	26.3	25.5	24.3	22.7	20.8	18.7	16.5	14.2		
	40	Q	165000	150000	137000	111000	89800	72000	57000	44300	33600			
		P	33.6	32.9	32.2	30.5	28.3	25.9	23.3	20.5	17.6			
	50	Q	143000	130000	118000	94600	76400	61000	47900	36900				
		P	40.1	38.9	37.6	35.0	31.9	28.6	25.1	21.6				

¹⁾ ASERCOM certified

Relating to 20 °C suction gas temperature without liquid subcooling

Motor version -S- (more powerful motor)

Supplementary cooling or reduced suction gas temperature

vap.bock.de





HG semi-hermetic compressors

Performance data

Type		Cooling capacity Q_o [kW]										Power consumption P_e [kW]	
Cond. temp. °C		Evaporating temperature °C											
		10	7,5	5	0	-5	-10	-15	-20	-25	-30	-35	-40
HGX66e/1750-4 HGX66e/1750-4 S	30	Q	212000	194000	177000	145000	118000	94900	75300	58900	45100	33600	
		P	30.5	30.4	30.1	29.1	27.7	25.9	23.8	21.4	18.9	16.4	
	40	Q	187000	171000	155000	127000	103000	82600	65300	50800	38600		
		P	38.3	37.6	36.8	34.8	32.3	29.6	26.6	23.5	20.2		
	50	Q	162000	147000	133000	109000	87600	69900	55000	42400			
		P	45.8	44.4	43.0	40.0	36.4	32.7	28.8	24.8			
HGX66e/2070-4 HGX66e/2070-4 S	30	Q	250000	228000	207000	171000	139000	112000	88700	69300	53100	39700	
		P	36.1	36.0	35.7	34.5	32.8	30.7	28.1	25.3	22.3	19.3	
	40	Q	219000	200000	182000	149000	121000	97000	76800	59800	45400		
		P	45.6	44.8	43.8	41.4	38.5	35.1	31.5	27.7	23.9		
	50	Q	189000	172000	156000	127000	103000	82000	64600	49900			
		P	54.7	53.1	51.3	47.8	43.5	38.9	34.2	29.3			
HGX88e/2400-4 HGX88e/2400-4 S	30	Q	296000	270000	246000	201000	163000	132000	105000	81400	62400	46500	
		P	42.7	42.5	42.2	40.8	38.9	36.4	33.5	30.3	26.9	23.3	
	40	Q	262000	239000	217000	176000	143000	115000	90500	70400	53400		
		P	53.2	52.3	51.1	48.8	45.4	41.6	37.4	33.1	28.7		
	50	Q	227000	207000	187000	151000	122000	97100	76300	58800			
		P	63.2	61.4	59.5	56.1	51.2	45.9	40.5	35.0			
HGX88e/2735-4 HGX88e/2735-4 S	30	Q	336000	307000	279000	230000	187000	150000	119000	93000	71200	53100	
		P	48.3	48.1	47.7	46.3	44.2	41.5	38.3	34.7	30.9	26.9	
	40	Q	297000	271000	246000	202000	164000	131000	104000	80400	61000		
		P	60.5	59.4	58.1	55.0	51.4	47.2	42.7	37.9	33.0		
	50	Q	258000	234000	212000	173000	140000	112000	87300	67200			
		P	72.2	70.1	67.9	63.0	57.7	52.0	46.1	40.0			
HGX88e/3235-4 HGX88e/3235-4 S	30	Q	397000	362000	330000	270000	220000	177000	140000	110000	83700	62300	
		P	56.9	56.7	56.2	54.5	52.0	48.7	44.9	40.6	36.0	31.3	
	40	Q	351000	320000	290000	237000	192000	154000	122000	94400	71600		
		P	71.3	69.9	68.4	65.1	60.6	55.5	50.0	44.3	38.4		
	50	Q	304000	276000	250000	203000	164000	131000	103000	78800			
		P	84.9	82.4	79.8	74.7	68.2	61.2	54.0	46.7			

Relating to 20 °C suction gas temperature without liquid subcooling

 Motor version -S- (more powerful motor)

 Supplementary cooling or reduced suction gas temperature

vap.bock.de



HG semi-hermetic compressors

Performance data

R22 | 50 Hz

Type		Cooling capacity Q_0 [kW]											Power consumption P_e [kW]	
		Evaporating temperature °C												
Cond. temp. °C		12.5	10	7.5	5	0	-5	-10	-15	-20	-25	-30	-35	
		HGX34e/380-4 HGX34e/380-4 S	30	Q 46700 5.82	42800 5.92	39100 5.97	35700 5.99	29600 5.91	24300 5.72	19800 5.43	16000 5.06	12700 4.64	9950 4.19	7690 3.73
40	Q 41000 7.60		37600 7.56	34400 7.49	31400 7.39	26100 7.08	21400 6.68	17400 6.21	14000 5.68	11200 5.12	8650 4.54			
50	Q 35500 9.31		32500 9.14	29800 8.93	27200 8.70	22500 8.16	18500 7.56	15000 6.89	12000 6.18					
HGX44e/475-4 HGX44e/475-4 S	30	Q 58200 7.16	53600 7.27	49100 7.34	45000 7.36	37500 7.29	30800 7.02	25100 6.68	20300 6.25	16100 5.73	12500 5.16	9390 4.55	6730 3.93	
	40	Q 52700 9.17	48300 9.15	44300 9.08	40500 8.97	33600 8.66	27400 8.19	22200 7.63	17800 6.99	14000 6.29	10700 5.54			
	50	Q 47000 11.0	43100 10.8	39300 10.6	35900 10.4	29600 9.90	24000 9.24	19300 8.46	15300 7.62					
HGX44e/565-4 HGX44e/565-4 S	30	Q 69400 8.50	63900 8.64	58600 8.71	53700 8.74	44800 8.65	36700 8.37	30000 7.96	24300 7.43	19300 6.81	15100 6.12	11400 5.39	8180 4.64	
	40	Q 62900 10.8	57700 10.8	52900 10.7	48400 10.6	40200 10.2	32600 9.79	26600 9.11	21300 8.33	16800 7.48	12900 6.58			
	50	Q 56300 13.1	51500 12.9	47100 12.6	43000 12.4	35500 11.7	28600 11.0	23200 10.1	18400 9.10					
HGX44e/665-4 HGX44e/665-4 S	30	Q 81000 9.95	74500 10.1	68300 10.1	62600 10.2	52100 10.1	43300 9.73	35300 9.26	28500 8.66	22600 7.94	17500 7.15	13200 6.30	9410 5.44	
	40	Q 73100 12.7	67100 12.7	61500 12.6	56200 12.5	46600 12.0	38400 11.3	31200 10.5	24900 9.69	19600 8.71	14900 7.68			
	50	Q 65200 15.4	59700 15.2	54600 14.9	49700 14.5	41000 13.8	33600 12.8	27000 11.7	21400 10.5					
HGX44e/770-4 HGX44e/770-4 S	30	Q 93900 11.5	86300 11.7	79200 11.8	72600 11.8	60500 11.7	50000 11.3	40900 10.8	33000 10.1	26200 9.28	20400 8.35	15400 7.36	11100 6.36	
	40	Q 84700 14.8	77800 14.8	71300 14.6	65200 14.5	54100 13.9	44500 13.2	36200 12.3	29000 11.3	22800 10.1	17500 8.97			
	50	Q 75600 17.9	69300 17.7	63300 17.3	57800 16.9	47700 16.0	39000 14.9	31500 13.6	25000 12.3					
HGX56e/850-4 HGX56e/850-4 S	30	Q 104000 12.7	95400 12.9	87600 13.0	80200 13.0	66900 12.9	55000 12.5	45000 11.9	36400 11.1	29000 10.2	22600 9.19	17100 8.10	12300 6.97	
	40	Q 93700 16.3	86000 16.2	78800 16.1	72100 15.9	59900 15.3	49000 14.6	39900 13.6	32000 12.4	25200 11.2	19400 9.88			
	50	Q 83700 19.6	76600 19.4	70100 19.0	64000 18.6	52900 17.6	43000 16.5	34800 15.1	27600 13.6					
HGX56e/995-4 HGX56e/995-4 S	30	Q 122000 14.9	112000 15.1	103000 15.2	93700 15.3	78000 15.1	64700 14.5	52800 13.8	42600 12.9	33800 11.8	26200 10.6	19700 9.42	14100 8.14	
	40	Q 110000 19.1	101000 19.1	91900 18.9	84000 18.7	69700 18.0	57400 16.9	46600 15.7	37300 14.4	29200 13.0	22300 11.4			
	50	Q 97500 23.1	89300 22.8	81600 22.4	74400 21.9	61300 20.7	50200 19.0	40400 17.4	32000 15.7					
HGX56e/1155-4 HGX56e/1155-4 S	30	Q 141000 18.0	130000 18.2	119000 18.4	109000 18.5	90700 18.3	74700 17.7	61000 16.9	49300 15.8	39200 14.4	30500 13.0	23100 11.4	16600 9.89	
	40	Q 128000 23.1	117000 23.0	107000 22.9	97800 22.6	81200 21.8	66500 20.7	54000 19.3	43300 17.7	34100 15.9	26100 14.0			
	50	Q 114000 27.9	105000 27.5	95100 27.0	86800 26.4	71700 24.9	58300 23.4	47000 21.4	37300 19.3					
HGX66e/1340-4 HGX66e/1340-4 S	30	Q 168000 21.4	155000 21.6	142000 21.7	131000 21.6	109000 21.2	89400 20.3	73100 19.2	59000 17.8	46800 16.2	36400 14.4	27700 12.6	20400 10.8	
	40	Q 152000 27.4	140000 27.1	128000 26.8	118000 26.3	97600 25.1	79700 23.5	64800 21.7	51900 19.7	40900 17.5	31400 15.3			
	50	Q 135000 32.8	124000 32.1	114000 31.3	104000 30.4	85600 28.4	69500 26.2	56100 23.8	44600 21.2					
HGX66e/1540-4 HGX66e/1540-4 S	30	Q 192000 24.6	177000 24.8	163000 24.9	150000 24.9	126000 24.4	103000 23.5	84200 22.2	68100 20.6	54200 18.8	42300 16.8	32300 14.7	24000 12.6	
	40	Q 174000 31.7	160000 31.4	147000 30.9	135000 30.4	113000 29.0	91800 27.3	74800 25.2	60200 22.9	47500 20.5	36700 17.9			
	50	Q 155000 38.1	142000 37.3	130000 36.3	119000 35.3	98600 33.1	80200 30.6	65000 27.8	51900 24.8					

Relating to 20 °C suction gas temperature without liquid subcooling

Motor version -S- (more powerful motor)

Supplementary cooling or reduced suction gas temperature

vap.bock.de



HG semi-hermetic compressors

Performance data

R22 50 Hz														
Type		Cooling capacity Q_0 [kW]										Power consumption P_e [kW]		
		Evaporating temperature °C												
		12.5	10	7.5	5	0	-5	-10	-15	-20	-25	-30	-35	
Cond. temp. °C		Q	P											
HGX66e/1750-4 HGX66e/1750-4 S	30	Q	218000	201000	185000	170000	142000	118000	96400	78000	62100	48500	37100	27500
		P	28.2	28.4	28.5	28.5	27.9	26.8	25.4	23.6	21.5	19.3	16.9	14.5
	40	Q	197000	182000	167000	153000	128000	7106000	85800	69000	54500	42200		
		P	36.2	35.8	35.4	34.8	33.2	31.2	28.8	26.2	23.5	20.6		
	50	Q	175000	161000	148000	135000	112000	91900	74600	59600				
		P	43.5	42.6	41.6	40.4	37.8	34.9	31.7	28.4				
HGX66e/2070-4 HGX66e/2070-4 S	30	Q	256000	236000	217000	200000	167000	139000	114000	91700	73100	57100	43700	32400
		P	33.3	33.6	33.7	33.7	33.0	31.8	30.0	27.9	25.4	22.7	19.9	17.1
	40	Q	231000	213000	196000	180000	150000	124000	101000	81100	64200	49700		
		P	43.0	42.6	42.0	41.3	39.4	37.1	34.2	31.1	27.8	24.3		
	50	Q	205000	189000	173000	158000	132000	108000	87500	70000				
		P	51.9	50.8	49.5	48.1	45.0	41.6	37.8	33.7				
HGX88e/2400-4 HGX88e/2400-4 S	30	Q	304000	280000	258000	237000	198000	163000	134000	108000	85900	67200	51400	38100
		P	39.6	39.9	40.0	40.0	39.3	37.6	35.7	33.2	30.4	27.3	24.1	20.8
	40	Q	276000	254000	233000	214000	179000	146000	119000	95500	75500	58500		
		P	50.3	49.9	49.2	48.4	46.3	43.8	40.6	37.0	33.1	29.2		
	50	Q	246000	226000	207000	190000	157000	128000	104000	82700				
		P	60.1	58.9	57.5	56.0	52.6	49.1	44.7	40.0				
HGX88e/2735-4 HGX88e/2735-4 S	30	Q	345000	318000	292000	269000	225000	186000	152000	123000	97900	76500	58500	43400
		P	44.7	45.1	45.3	45.2	44.4	42.8	40.6	37.8	34.7	31.2	27.5	23.8
	40	Q	313000	288000	265000	243000	202000	167000	136000	109000	86100	66600		
		P	57.2	56.6	55.9	55.0	52.6	49.6	46.0	42.0	37.7	33.3		
	50	Q	279000	256000	235000	215000	179000	146000	119000	94300				
		P	68.6	67.2	65.5	63.8	59.8	55.5	50.6	45.4				
HGX88e/3235-4 HGX88e/3235-4 S	30	Q	407000	376000	346000	317000	266000	219000	180000	145000	116000	90100	68800	51000
		P	52.7	53.1	53.3	53.2	52.3	50.4	47.8	44.5	40.7	36.6	32.3	27.9
	40	Q	370000	340000	313000	286000	239000	196000	160000	129000	102000	78300		
		P	67.3	66.7	65.8	64.7	61.8	58.4	54.1	49.4	44.3	39.0		
	50	Q	329000	303000	277000	254000	210000	172000	140000	111000				
		P	80.7	79.0	77.1	75.0	70.3	65.4	59.5	53.3				

Relating to 20 °C suction gas temperature without liquid subcooling

Motor version -S- (more powerful motor)

Supplementary cooling or reduced suction gas temperature

vap.bock.de



HG semi-hermetic compressors

Technical data

HG

Type	Number of cylinders	Displacement		Electrical data						Weight	Connections ⁵⁾				Oil charge	Frequency range	
		m ³ /h		Voltage ¹⁾	Max. Working current ²⁾		Max. Power consumption ²⁾	Starting current (rotor locked)			Discharge line DV		Suction line SV				
		50 Hz 1450 rpm	60 Hz 1740 rpm		Δ	Y		kW	Δ		Y	A	A	kg			mm
HG12P/60-4 S	2	5.40	6.40	³⁾	6.8	3.9	2.2	40	23	48.0	12	1/2	16	5/8	0.8	30-70	
HG12P/75-4	2	6.70	8.10	³⁾	7.1	4.1	2.3	40	23	48.0	12	1/2	16	5/8	0.8	30-70	
HG12P/75-4 S	2	6.70	8.10	³⁾	8.0	4.6	2.6	43	25	49.0	12	1/2	16	5/8	0.8	30-70	
HG12P/90-4	2	8.00	9.60	³⁾	8.5	4.9	2.8	43	25	49.0	12	1/2	16	5/8	0.8	30-70	
HG12P/90-4 S	2	8.00	9.60	³⁾	9.1	5.3	3.0	45	26	49.0	12	1/2	16	5/8	0.8	30-70	
HG12P/110-4	2	9.40	11.30	³⁾	9.2	5.3	3.1	43	25	49.0	12	1/2	16	5/8	0.8	30-70	
HG12P/110-4 S	2	9.40	11.30	³⁾	10.6	6.1	3.6	45	26	49.0	12	1/2	16	5/8	0.8	30-70	
HG22e/125-4	2	11.10	13.30	³⁾	9.3	5.4	3.0	69	40	74.0	16	5/8	22	7/8	1.0	30-70	
HG22e/125-4 S	2	11.10	13.30	³⁾	10.8	6.2	3.6	69	40	74.0	16	5/8	22	7/8	1.0	30-70	
HG22e/160-4	2	13.70	16.40	³⁾	11.1	6.4	3.7	69	40	74.0	16	5/8	22	7/8	1.0	30-70	
HG22e/160-4 S	2	13.70	16.40	³⁾	13.1	7.6	4.4	87	50	76.0	16	5/8	22	7/8	1.0	30-70	
HG22e/190-4	2	16.50	19.80	³⁾	13.8	8.0	4.8	69	40	74.0	16	5/8	22	7/8	1.0	30-70	
HG22e/190-4 S	2	16.50	19.80	³⁾	16.2	9.4	5.6	87	50	75.0	16	5/8	22	7/8	1.0	30-70	
HG34e/215-4	4	18.80	22.60	³⁾	14.0	8.1	4.8	87	50	92.0	22	7/8	28	1 1/8	1.2	25-70	
HG34e/215-4 S	4	18.80	22.60	³⁾	18.3	10.5	6.0	132	76	97.0	22	7/8	28	1 1/8	1.2	25-70	
HG34e/255-4	4	22.10	26.60	³⁾	17.0	9.8	6.0	87	50	92.0	22	7/8	28	1 1/8	1.2	25-70	
HG34e/255-4 S	4	22.10	26.60	³⁾	21.1	12.2	7.2	132	76	96.0	22	7/8	28	1 1/8	1.2	25-70	
HG34e/315-4	4	27.30	32.80	³⁾	21.1	12.2	7.4	111	64	94.0	22	7/8	28	1 1/8	1.2	25-70	
HG34e/315-4 S	4	27.30	32.80	³⁾	25.5	14.7	8.9	132	76	97.0	22	7/8	28	1 1/8	1.2	25-70	
HG34e/380-4	4	33.10	39.70	³⁾	26.1	15.1	9.3	111	64	93.0	22	7/8	28	1 1/8	1.2	25-70	
HG34e/380-4 S	4	33.10	39.70	³⁾	31.2	18.0	11.1	132	76	96.0	22	7/8	28	1 1/8	1.2	25-70	
					PW 1+2'			PW1/PW1+2'									
HG44e/475-4	4	41.30	49.60	⁴⁾	19.0		11.0	83	109	164.0	28	1 1/8	35	1 3/8	2.3	25-70	
HG44e/475-4 S	4	41.30	49.60	⁴⁾	23.0		13.1	115	150	168.0	28	1 1/8	35	1 3/8	2.3	25-70	
HG44e/565-4	4	49.20	59.00	⁴⁾	22.0		13.2	83	109	164.0	28	1 1/8	35	1 3/8	2.3	25-70	
HG44e/565-4 S	4	49.20	59.00	⁴⁾	26.0		15.6	133	171	170.0	28	1 1/8	42	1 5/8	2.3	25-70	
HG44e/665-4	4	57.70	69.20	⁴⁾	26.0		15.4	115	150	171.0	28	1 1/8	42	1 5/8	2.3	25-70	
HG44e/665-4 S	4	57.70	69.20	⁴⁾	30.0		18.3	133	171	168.0	28	1 1/8	42	1 5/8	2.3	25-70	
HG44e/770-4	4	67.00	80.40	⁴⁾	30.0		17.8	133	171	168.0	28	1 1/8	42	1 5/8	2.3	25-70	
HG44e/770-4 S	4	67.00	80.40	⁴⁾	35.0		21.4	133	171	168.0	28	1 1/8	42	1 5/8	2.3	25-70	
HG56e/850-4	6	73.80	88.60	⁴⁾	32.6		19.7	133	171	194.3	35	1 3/8	54	2 1/8	2.7	25-70	
HG56e/850-4 S	6	73.80	88.60	⁴⁾	39.4		23.5	162	210	211.1	35	1 3/8	54	2 1/8	2.7	25-70	
HG56e/995-4	6	86.60	103.90	⁴⁾	38.9		23.2	162	210	194.3	35	1 3/8	54	2 1/8	2.7	25-70	
HG56e/995-4 S	6	86.60	103.90	⁴⁾	46.4		27.7	189	246	211.3	35	1 3/8	54	2 1/8	2.7	25-70	
HG56e/1155-4	6	100.40	120.50	⁴⁾	46.9		28.0	189	246	211.8	35	1 3/8	54	2 1/8	2.7	25-70	
HG56e/1155-4 S	6	100.40	120.50	4)	58.3		33.3	253	330	220.6	35	1 3/8	54	2 1/8	2.7	25-70	

¹⁾PW - Part Winding, motors for part winding start

1 - first part winding

2 - second part winding

HG semi-hermetic compressors

Technical data

HG															
Type	Number of cylinders	Displacement		Voltage ¹⁾	Electrical data				Weight	Connections ⁵⁾				Oil charge	Frequency range
		50 Hz/60Hz (1450/1740 rpm)			Max. Working current ²⁾	Max. Power consumption ²⁾	Starting current (rotor locked)			Discharge line DV		Suction line SV			
		m ³ /h	m ³ /h				A	kW		A	A	mm	inch		
		50 Hz 1450 rpm	60 Hz 1740 rpm		Δ	Y		Δ	Y						
HG66e/1340-4	6	116.50	139.80	⁴⁾	53.7	31.9	170	275	282.0	42	1 5/8	54	2 1/8	4.4	25-60
HG66e/1340-4 S	6	116.50	139.80	⁴⁾	65.3	38.1	196	335	287.0	42	1 5/8	54	2 1/8	4.4	25-60
HG66e/1540-4	6	133.80	160.50	⁴⁾	62.1	37.2	170	275	280.0	42	1 5/8	54	2 1/8	4.4	25-60
HG66e/1540-4 S	6	133.80	160.50	⁴⁾	75.0	44.4	196	335	285.0	42	1 5/8	54	2 1/8	4.4	25-60
HG66e/1750-4	6	152.20	182.60	⁴⁾	71.9	42.4	196	335	280.0	42	1 5/8	54	2 1/8	4.4	25-60
HG66e/1750-4 S	6	152.20	182.60	⁴⁾	86.8	50.7	222	361	282.0	42	1 5/8	54	2 1/8	4.4	25-60
HG66e/2070-4	6	180.00	216.00	⁴⁾	85.1	50.7	196	335	276.0	42	1 5/8	64	2 1/8	4.4	25-60
HG66e/2070-4 S	6	180.00	216.00	⁴⁾	103.0	60.7	222	361	278.0	42	1 5/8	64	2 1/8	4.4	25-60
HG88e/2400-4	8	209.10	250.90	⁴⁾	101.0	59.5	298	438	452.0	54	2 1/8	76	3 1/8	9.6	25-60
HG88e/2400-4 S	8	209.10	250.90	⁴⁾	120.0	69.8	447	657	452.0	54	2 1/8	76	3 1/8	9.6	25-60
HG88e/2735-4	8	237.90	285.50	⁴⁾	116.0	67.1	386	567	455.0	54	2 1/8	76	3 1/8	9.6	25-60
HG88e/2735-4 S	8	237.90	285.50	⁴⁾	136.0	80.0	447	657	464.0	54	2 1/8	76	3 1/8	9.6	25-60
HG88e/3235-4	8	281.30	337.60	⁴⁾	135.0	79.2	447	657	459.0	54	2 1/8	76	3 1/8	9.6	25-60
HG88e/3235-4 S	8	281.30	337.60	⁴⁾	162.0	93.9	538	791	467.0	54	2 1/8	76	3 1/8	9.6	25-60

¹⁾PW - Part Winding, motors for part winding start

1 - first part winding

2 - second part winding

Explanations

- 1) Tolerance (± 10 %) relates to the mean value of the voltage range. Other voltages and current types on request.
- 2) • The specifications for max. power consumption apply for 50 Hz operation. For 60 Hz operation, the specifications have to be multiplied by the factor 1.2. The max. working current remains unchanged.
 - Take account of the max. operating current / max. power consumption when designing contactors, leads and fuses. Switches: Service category AC3

- 3) 220 – 240 V Δ / 380 – 420 V Y - 3 - 50 Hz,
265 – 290 V Δ / 440 – 480 V Y - 3 - 60 Hz

- 4) PW = Part Winding, motors for part winding start (no start unloaders required)

- Winding ratios:
HG44e, HG56e, HG66e, HG88e = 50 % / 50 %
- Designs for Y/Δ on request

- 5) For soldering connections

Oil sump heater 110-240 V - 1 - 50 / 60 Hz (option)

- HG12P, HG22e, HG34e: 50-120 W
- PTC heater, self-regulating, installation in housing bore

Oil sump heater 230 V - 1 - 50 / 60 Hz (option)

- HG44e, HG56e, HG66e: 160 W, installation in housing bore
- HG88e: 200 W, installation in immersion sleeve
- Permanently set version

HG semi-hermetic compressors

Dimensions and connections

HG56e » HG56e/850-4 » HG56e/850-4 S » HG56e/995-4
 HG56e/995-4 S » HG56e/1155-4 » HG56e/1155-4 S

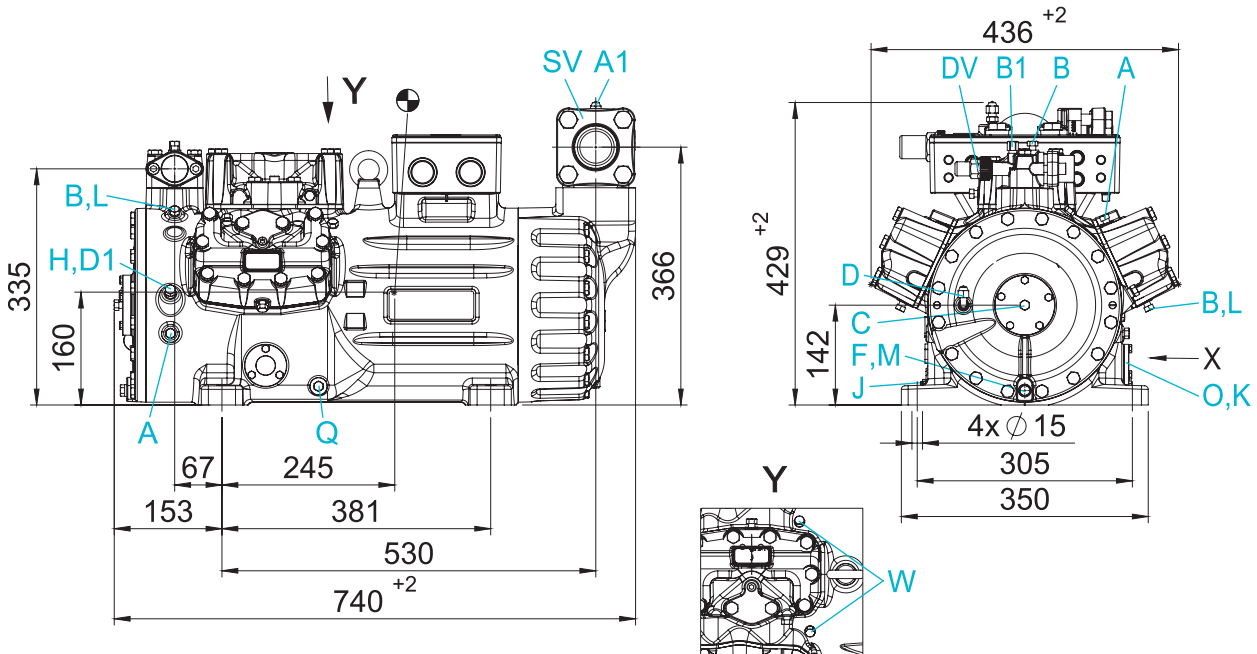

HG66e » HG66e/1340-4 » HG66e/1340-4 S » HG66e/1540-4 » HG66e/1540-4 S
 HG66e/1750-4 » HG66e/1750-4 S » HG66e/2070-4 » HG66e/2070-4 S

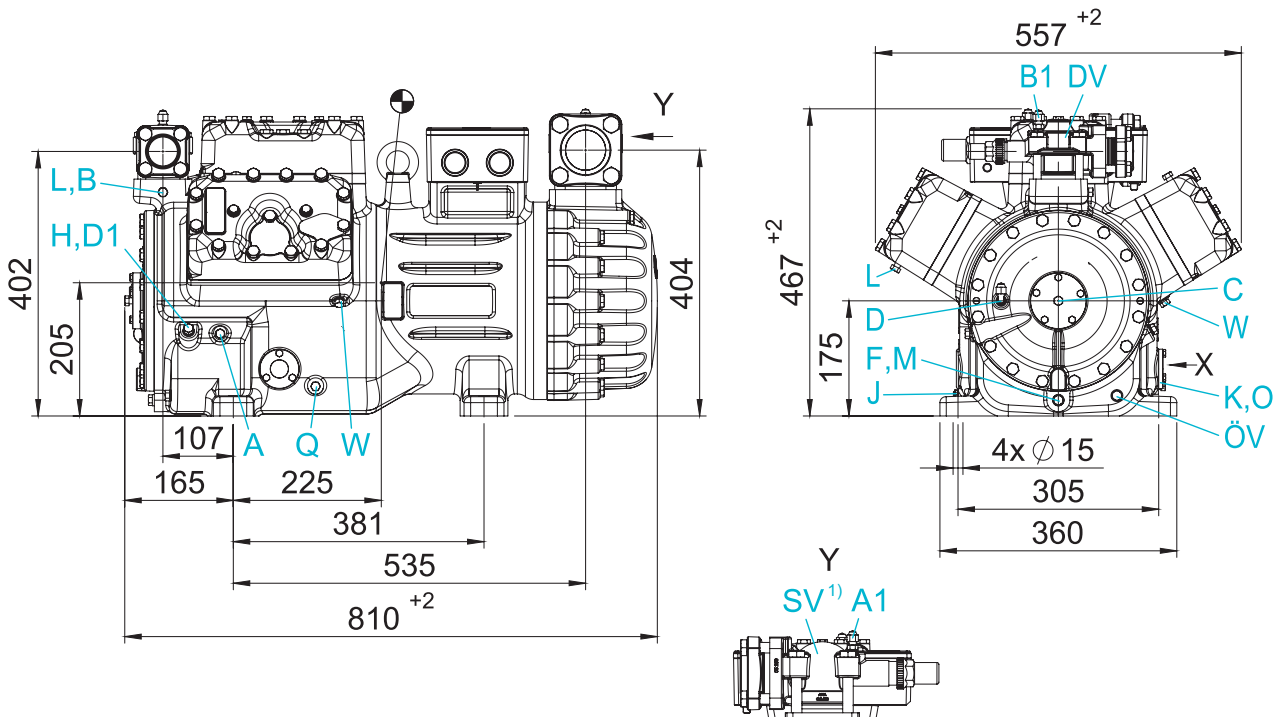

Dimensions in mm
 ● Center of gravity
¹⁾ SV 180° rotatable

Connections see page 64
 Dimensions for anti-vibration pad see page 61

HG semi-hermetic compressors

Dimensions and connections

HG88e » HG88e/2400-4 » HG88e/2400-4 S » HG88e/2735-4
HG88e/2735-4 S » HG88e/3235-4 » HG88e/3235-4 S

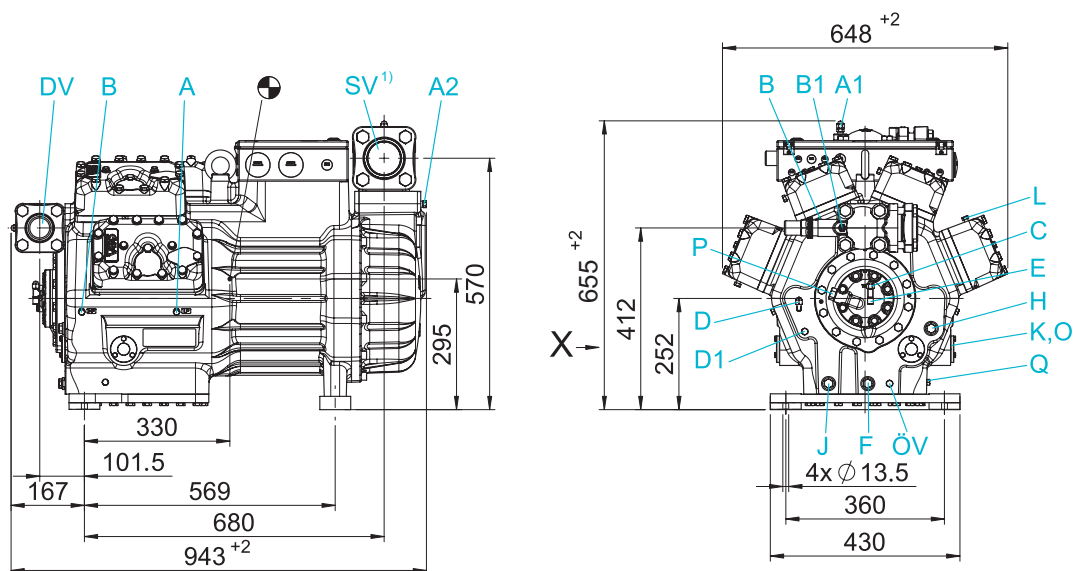

Dimensions in mm

● Center of gravity

¹⁾ SV 180° rotatable

Connections see page 64

Dimensions for anti-vibration pad see below

View X

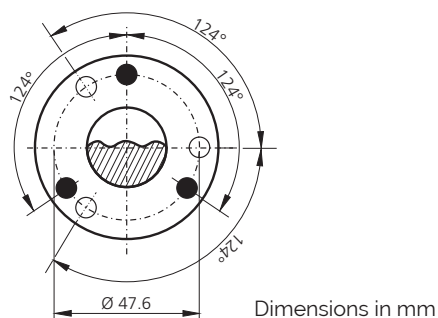

Possibility to connect to oil level regulator

HG44e, HG56e, HG66e, HG88e

- Three-hole connection for oil level regulator of brands ESK, AC+R, CARLY (3 x M6 x 10 deep)
- Three-hole connection for oil level regulator of brand TRAXOIL (3 x M6 x 10 deep)

Dimensions for anti-vibration pad

Type	Ø a	b	c	d
HG12P	30	30	M8	20
HG22e	40	30	M10	20
HG34e	40	30	M10	20
HG44e	50	30	M12	25
HG56e	50	30	M12	25
HG66e	50	30	M12	25
HG88e	70	45	M12	37

Dimensions in mm

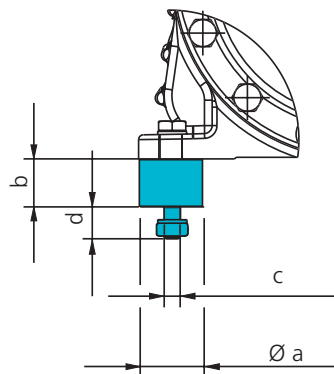

HG semi-hermetic compressors

Dimensions and connections

HG12P HG22e HG34e HG44e HG56e

Dimensions with accessories

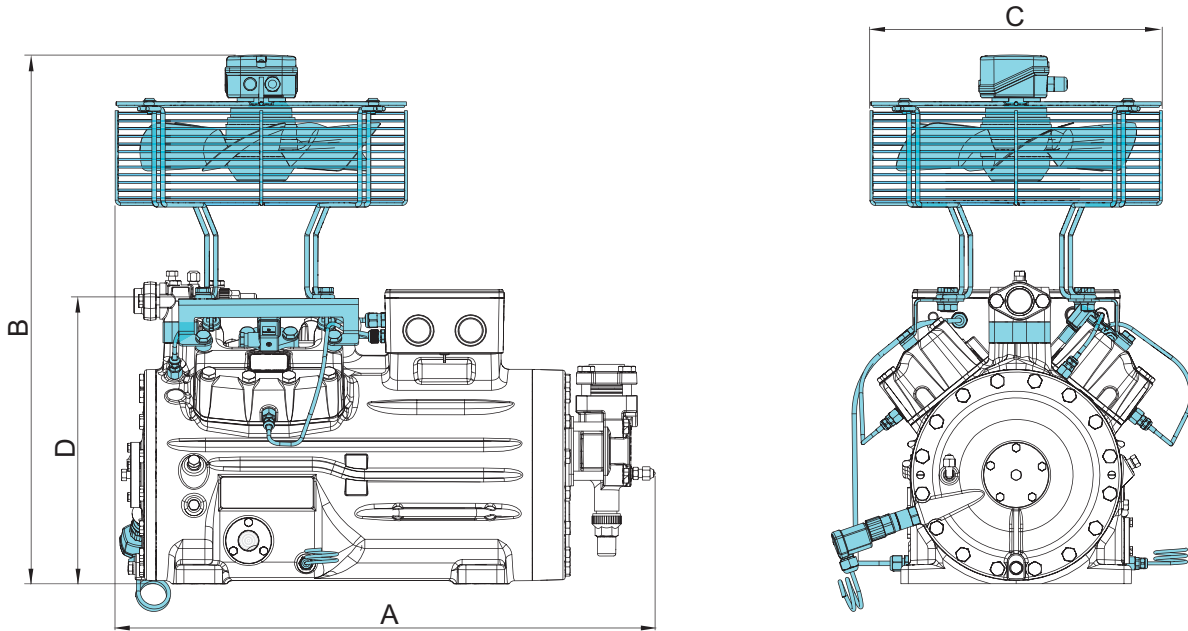

Type	A	B	C	D
HG12P	ca. 460	ca. 500	ca. 315	-
HG22e	ca. 525	ca. 610	ca. 380	-
HG34e	ca. 580	ca. 640	ca. 380	-
HG44e	ca. 710	ca. 685	ca. 380	368
HG56e	-	ca. 710	ca. 380	-

Dimensions in mm

HG semi-hermetic compressors

Dimensions and connections

HG66e

Dimensions with accessories

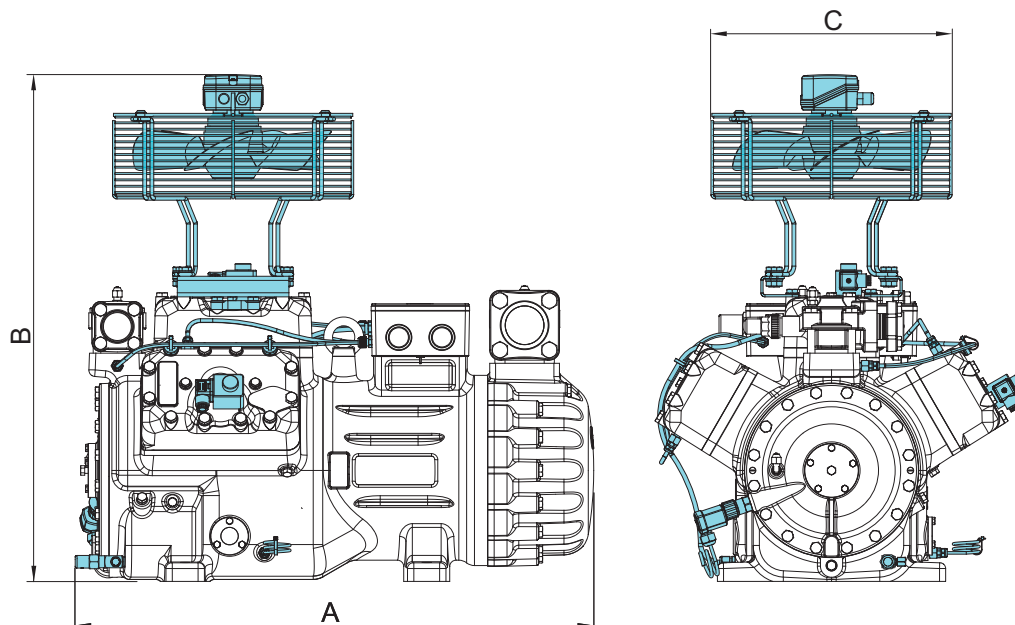

Type

A

B

C

HG66e

ca. 820

ca. 800

ca. 380

Dimensions in mm

HG88e

Dimensions with accessories

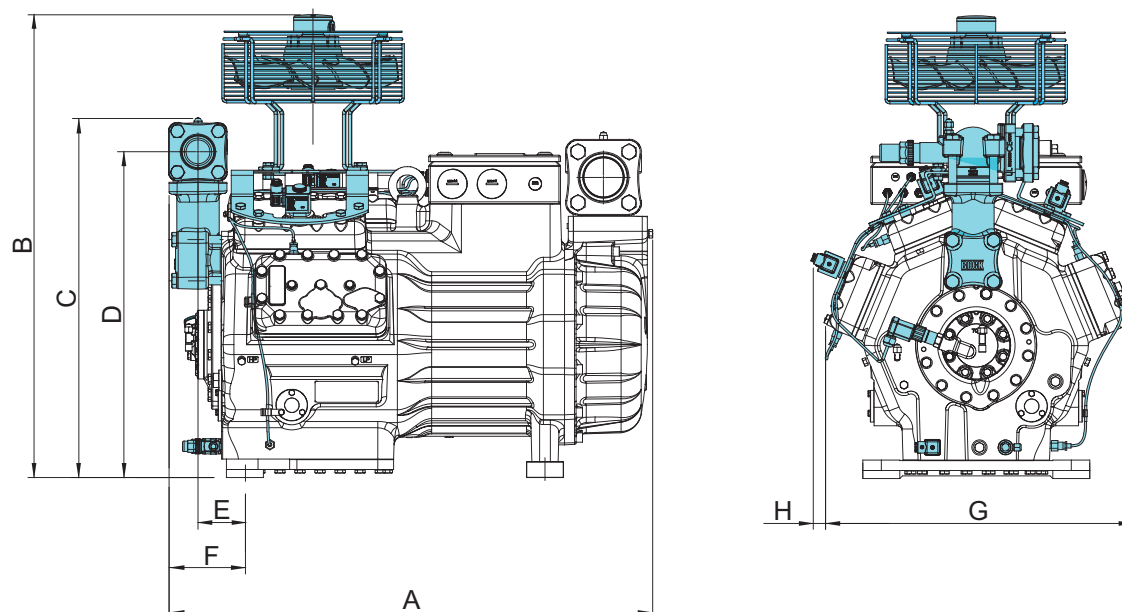

Type

A

B

C

D

E

F

G

H

HG88e

ca. 920

ca. 880

ca. 680

617

90

145

ca. 610

ca. 20

Dimensions in mm